

Components comply with DIN 2353, DIN EN ISO 8434-1  
AG = Special silver coated nut  
AGM = Tube fitting complete with special silver coated nut

Bauteile nach DIN 2353, DIN EN ISO 8434-1  
AG = Speziell silberveredelte Mutter  
AGM = Rohrverschraubung komplett mit speziell silberveredelter Mutter

**The profile ring in stainless steel**

**Protecting man and environment - WALTERSCHEID Technology, proven a million times over, now available in stainless steel!**

Corrosive media and extreme conditions of use call for special materials. Walpro-X was developed specifically for use in critical, high-dependability situations. In short, wherever safety and the protection of the environment are of prime importance.

**ADVANTAGES** at a glance

- Unique max. capacity of L-series, 400 bar nominal pressure; max. capacity of S-series, 630 bar nominal pressure.
- 100 % reproducible assembly, thanks to WALTERSCHEID final assembly machines
- Special, silver-coated AGP nuts
- Components comply with DIN 2353, DIN EN ISO 8434-1

**Der Profilring in Edelstahl**

**Zur Sicherheit für Mensch und Umwelt: millionenfach bewährte WALTERSCHEID-Technik auch in Edelstahl!**

Aggressive Medien und extreme Einsatzbereiche verlangen besondere Lösungen. Walpro-X wurde speziell für den Einsatz in hochsensiblen und sicherheitsrelevanten Bereichen entwickelt - überall dort, wo es um Sicherheit und den Schutz der Umwelt geht.

**VORTEILE** auf einen Blick

- Einzigartige max. 400 bar Nenndruck in der L-Baureihe / Nenndruck bis max. 630 bar in der S-Baureihe
- 100%ig reproduzierbare Montageergebnisse durch WALTERSCHEID-Endmontagemaschinen
- Speziell silberveredelte AGP-Mutter
- Bauteile nach DIN 2353, DIN EN ISO 8434-1



**Design and choice of material determine success - reliable, secure and durable**

**WALFORMplus, one of the world's most dependable tube connecting systems, is now available in a new design to meet the most demanding requirements.**

The WALFORMplus positive-locking connecting system guarantees complete reliability, even under high static and dynamic loads. In stainless steel, it is wider than the average joint and can be used, in particular, in critical situations or where the emphasis is on safety.

**Advantes** at a glance

- Unique max. capacity of L-series, 400 bar nominal pressure; max. capacity of S-series, 630 bar nominal pressure
- Workmanship of the utmost reliability assured by failsafe provisions against faulty assembly
- Special, silver-coated AGP nuts
- DIN 2353, DIN EN ISO 8434-1

**Die Form und der Werkstoff bestimmen den Erfolg - sicher, dicht und beständig.**

**Eines der sichersten Rohrverbindungssysteme - in neuer Ausführung für höchste Anforderungen!**



Das formschlüssige Verschraubungssystem WALFORMplus bietet absolute Sicherheit selbst bei hohen statischen und dynamischen Belastungen. In Edelstahl ist es noch breiter und für besonders sensible und sicherheitsrelevante Bereiche einsetzbar.

**VORTEILE** auf einen Blick

- Einzigartige max. 400 bar Nenndruck in der L-Baureihe / bis max. 630 bar in der S-Baureihe
- Höchste Arbeitssicherheit durch hohe Toleranz gegenüber Montagefehlern
- Speziell silberveredelte AGP-Mutter
- DIN 2353, DIN EN ISO 8434-1



*Powering Business Worldwide*

Designation Bezeichnung	Typ Type		Page Seite
Connecting parts for profile ring tube fittings 1.4571 Rohr-Anschlussstück für Profiling-Rohrverschraubungen 1.4571			
Nut / Profile ring (LL=Cutting ring) Überwurfmutter / Profiling (LL=Schneidring)		M ... (S) P-R ..	1
Connecting parts for WALFORMplus tube fittings Rohr-Anschlussstücke für WALFORMplus-Rohrverschraubungen 1.4571			
Nut / Captive seal FPM (Viton) / Support sleeves for thin wallthicknesses Überwurfmutter / Weichdichtung FPM (Viton) / Stützringe für dünne Wandstärken		M ... WF-WD ... VI WF-WD-Stützring ...	1
Connecting parts for flare tube fittings 1.4571 Rohr-Anschlussstücke für Bördel-Rohrverschraubungen 1.4571			
Flare connecting part complete consisting of: Centre unit / Loose sleeve / Nut Bördelanschluss komplett bestehend aus: Zwischenring / Druckring / Überwurfmutter		BO-A ... BO-ZR / BO-DR / BO-M	2
			
	<b>Tube fitting</b> (with nuts and rings) <b>Rohrverschraubung</b> (mit Muttern und Ringen)	<b>Body only</b> (without nuts and rings) <b>Stutzen</b> (ohne Muttern und Ringe)	
Male stud coupling Gerade Einschraubverschraubung	(S) P-GEV ... RK (S) P-GEV ... MK (S) P-GEV ... NPT (S) P-GEV ... R (S) P-GEV ... M P-GEV ... R-WD-VI P-GEV ... M-WD-VI	GES ... RK GES ... MK GES ... NPT GES ... R GES ... M GES ... R-WD-VI GES ... M-WD-VI	3 3 3/4 5/6 7 7/8 9
Male stud elbow Winkel-Einschraubverschraubung	(S) P-WEV ... RK (S) P-WEV ... MK (S) P-WEV ... NPT	WES ... RK WES ... MK WES ... NPT	9 10 10
Straight coupling Gerade Verschraubung	(S) P-GV ...	GS ...	11
Straight reducing coupling Gerade-Reduzierschraubung	(S) P-GV ... / ...	GS ... / ...	11
Equal elbow Winkel-Verschraubung	(S) P-WV ...	WS ...	12
Equal tee Kreuz-Verschraubung	(S) P-TV ...	TS ...	12
Equal cross Kreuz-Verschraubung	(S) P-KV ...	KS ...	13
Straight bulkhead coupling with hexagon nut Gerade-Schottverschraubung mit Sechskantmutter	(S) P-GSV ... m. 6kt M	GSS ... m. 6kt-M	14
Bulkhead elbow coupling with hexagon nut Winkel-Schottverschraubung mit Sechskantmutter	(S) P-WSV ... m. 6kt-M	WSS ... m. 6kt-M	14
Hexagon nut for bulkhead coupling and bulkhead body Sechskantmutter für Schottverschraubung / -stutzen		SKM ...	14
Weldable stud Anschweiß-Verschraubung	P-ASV ...	ASS ...	15
Weldable bulkhead coupling Einschweiß-Schottverschraubung	P-ESV ...	ESS ...	15
Banjo coupling with one-piece bolt Winkel-Schwenkverschraubung	P-RSWV ... R-WD-VI (S) P-RSWV ... R-VI P-RSWV ... M-WD-VI (S) P-RSWV ... M-VI	RSWS ... R-WD-VI RSWS ... R-VI RSWS ... M-WD-VI RSWS ... M-VI	16 16 17 17
Adjustable male stud elbow Einstellbare Winkel-Verschraubung	P-EWV ... -SV P-EWVD ... -VI	P-EWS ... -SV EWSD ... -VI	18 18
Adjustable brunch tee Einstellbare T-Verschraubung	P-ETV ... -SV P-ETVD ... -VI	P-ETS ... -SV ETSD ... -VI	19 19

Designation Bezeichnung	Typ Type	Page Seite	
	<b>WALPROX</b>		
	<b>Tube fitting</b> (with nuts and rings) <b>Rohrverschraubung</b> (mit Muttern und Ringen)	<b>Body only</b> (without nuts and rings) <b>Stutzen</b> (ohne Muttern und Ringe)	
		Seite Page	
Adjustable male stud run tee Einstellbare L-Verschraubung	P-ELV ... -SV P-ELVD ... -VI	P-ELS ... -SV ELSD ... -VI	20 20
Stud standpipe adaptor Gerade Einschraubstutzen	P-EGES ... R-WD-VI-SV EGESD ... R-WD-VI P-EGES ... M-WD-VI-SV EGESD ... M-WD-VI EGESD ... NPT-VI		21 21 21 21 22
Straight couling Gerade-Verbindung	SNV ... -VI		22
Non-return-valve Rückschlagventil	P-RV ...	RS ...	22
Non-return-valve with male stud Einschraub-Rückschlagventile	P-RVV ... R-WD-VI P-RVV ... M-WD-VI P-RVZ ... R-WD-VI P-RVZ ... M-WD-VI	RSV ... R-WD-VI RSV ... M-WD-VI RSZ ... R-WD-VI RSZ ... M-WD-VI	23 23 24 24
Reducing fitting Reduzierschraubung	P-REDV ... / ... -SV P-REDVD ... / ... -VI	P-REDS ... / ... -SV REDSD ... / ... -VI	25 26/27
Reducing adaptor Gewinde-Reduzierstutzen	RED-R ... -WD-VI / R ...		28
Parallel female stud coupling Gerade-Aufschraubverschraubung	P-GAV ... R	GAS ... R	28
Adjustable gauge coupling Einstellb. Manometer-Aufschraubstutzen	EMASD ... R-VI		28
Manometer gauge coupling Manometer-Aufschraubverschraubung	P-MAV ... R	MAS ... R	29
Sealing ring for manometer gauge coupling Dichtkantenringe f. Manometer-Verschraubung		DKR-R ...	29
Blanking plug with limit stop for assembly Verschlußstopfen mit Montagebegrenzung	VSD ... M.MB-VI		29
Verschlußschraube Blanking end	VS-R ... -WD-VI VS-M ... -WD-VI		29 29
Tube insert Einsteckhülse	EH ...		30
Welding nipple Schweißnippel	SN ... x ... -VI		30
A B F Antibloc-Grease (Special lubricant for the installation of stainless steel couplings Material 1.4571) A B F Anti-Bloc-Fett (Spezialfett zur Montage von Edelstahl-Verschraubungen 1.4571)		ABF ...	30

**General information**

Components comply with DIN 2353, DIN EN ISO 8434-1  
AG = Special silver coated nut  
AGM = Tube fitting complete with special silver coated nut

**Allgemeine Informationen**

Bauteile nach DIN 2353, DIN EN ISO 8434-1  
AG = Speziell silberveredelte Mutter  
AGM = Rohrverschraubung komplett mit speziell silberveredelter Mutter

**Connecting parts for profile ring tube fittings 1.4571**

**Rohr-Anschlusssteile für Profilring-Rohrverschraubungen 1.4571**



Nut  
Überwurfmutter



Typ	Reference Bestell-Nr.
<b>M ... 1.4571-AG</b>	
M 15 L-1.4571-AG	WAL618859
M 18 L-1.4571-AG	WAL618860
M 22 L-1.4571-AG	WAL618861
M 28 L-1.4571-AG	WAL618862
M 35 L-1.4571-AG	WAL618863
M 42 L-1.4571-AG	WAL618864
M 12 S-1.4571-AG	WAL618865
M 14 S-1.4571-AG	WAL618866
M 16 S-1.4571-AG	WAL618867
M 20 S-1.4571-AG	WAL618868
M 25 S-1.4571-AG	WAL618869
M 30 S-1.4571-AG	WAL618870
M 38 S-1.4571-AG	WAL618871

Typ	Reference Bestell-Nr.
<b>M ... 1.4571</b>	
M 4 LL-1.4571	WAL027923
M 6 LL-1.4571	WAL027925
M 8 LL-1.4571	WAL027926
M 6 L-1.4571	WAL027927
M 8 L-1.4571	WAL027928
M 10 L-1.4571	WAL027929
M 12 L-1.4571	WAL027930
M 15 L-1.4571	WAL027931
M 18 L-1.4571	WAL027932
M 22 L-1.4571	WAL027933
M 28 L-1.4571	WAL027934
M 35 L-1.4571	WAL027935
M 42 L-1.4571	WAL027936
M 6 S-1.4571	WAL028649
M 8 S-1.4571	WAL027937
M 10 S-1.4571	WAL027938
M 12 S-1.4571	WAL027939
M 14 S-1.4571	WAL027940
M 16 S-1.4571	WAL027941
M 20 S-1.4571	WAL027942
M 25 S-1.4571	WAL027943
M 30 S-1.4571	WAL027944
M 38 S-1.4571	WAL027945

Profile ring  
Profiling

(LL=Cutting ring)  
(LL=Schneidring)



Typ	Reference Bestell-Nr.
<b>S-R/P-R ... 1.4571</b>	
S-R 4 LL-1.4571	WAL029780
S-R 6 LL-1.4571	WAL029782
S-R 8 LL-1.4571	WAL029783
P-R 6 L-1.4571	WAL618843
P-R 8 L-1.4571	WAL618844
P-R 10 L-1.4571	WAL618845
P-R 12 L-1.4571	WAL618846
P-R 15 L-1.4571	WAL618847
P-R 18 L-1.4571	WAL618848
P-R 22 L-1.4571	WAL618849
P-R 28 L-1.4571	WAL618850
P-R 35 L-1.4571	WAL618851
P-R 42 L-1.4571	WAL618852
P-R 6 S-1.4571	WAL618843
P-R 8 S-1.4571	WAL618844
P-R 10 S-1.4571	WAL618845
P-R 12 S-1.4571	WAL618846
P-R 14 S-1.4571	WAL618853
P-R 16 S-1.4571	WAL618854
P-R 20 S-1.4571	WAL618855
P-R 25 S-1.4571	WAL618856
P-R 30 S-1.4571	WAL618857
P-R 38 S-1.4571	WAL618858

**Connecting parts for WALFORM plus tube fittings 1.4571**

**Rohr-Anschlusssteile für WALFORM plus-Rohrverschraubungen 1.4571**



Nut  
Überwurfmutter



Typ	Reference Bestell-Nr.
<b>M ... 1.4571-AG</b>	
M 15 L-1.4571-AG	WAL618859
M 18 L-1.4571-AG	WAL618860
M 28 L-1.4571-AG	WAL618862
M 35 L-1.4571-AG	WAL618863
M 42 L-1.4571-AG	WAL618864
M 12 S-1.4571-AG	WAL618865
M 14 S-1.4571-AG	WAL618866
M 16 S-1.4571-AG	WAL618867
M 20 S-1.4571-AG	WAL618868
M 25 S-1.4571-AG	WAL618869
M 30 S-1.4571-AG	WAL618870
M 38 S-1.4571-AG	WAL618871

Typ	Reference Bestell-Nr.
<b>M ... 1.4571</b>	
M 6 L-1.4571	WAL027927
M 8 L-1.4571	WAL027928
M 10 L-1.4571	WAL027929
M 12 L-1.4571	WAL027930
M 15 L-1.4571	WAL027931
M 18 L-1.4571	WAL027932
M 28 L-1.4571	WAL027934
M 35 L-1.4571	WAL027935
M 42 L-1.4571	WAL027936
M 6 S-1.4571	WAL028649
M 8 S-1.4571	WAL027937
M 10 S-1.4571	WAL027938
M 12 S-1.4571	WAL027939
M 14 S-1.4571	WAL027940
M 16 S-1.4571	WAL027941
M 20 S-1.4571	WAL027942
M 25 S-1.4571	WAL027943
M 30 S-1.4571	WAL027944
M 38 S-1.4571	WAL027945

Captive seal  
Weichdichtung  
FPM (Viton)  
FPM (Viton)



Typ	Reference Bestell-Nr.
<b>WF-WD ... Viton</b>	
WF-WD 6 L/S VI	WAL610871
WF-WD 8 L/S VI	WAL610872
WF-WD 10 L/S VI	WAL610873
WF-WD 12 L/S VI	WAL610874
WF-WD 15 L VI	WAL610875
WF-WD 18 L VI	WAL610877
WF-WD 28 L VI	WAL610881
WF-WD 35 L VI	WAL610883
WF-WD 42 L VI	WAL610885
WF-WD 16 S VI	WAL610876
WF-WD 20 S VI	WAL610878
WF-WD 25 S VI	WAL610880
WF-WD 30 S VI	WAL610882
WF-WD 38 S VI	WAL610884

Support sleeves for  
thin-walled tubes  
Stützringe für dünne  
Wandstärken



WF-WD-Stützring ... ... 1.4571	Reference Bestell-Nr.
6 x 1,0 L/S-1.4571	WAL625476
8 x 1,0 L/S-1.4571	WAL625477
10 x 1,0 L/S-1.4571	WAL625478
12 x 1,0 L/S-1.4571	WAL625479

**Connecting parts for flare tube fittings 1.4571**  
**Rohr-Anschlussstelle für Bördel-Rohrverschraubungen 1.4571**

**Flare connecting part complete**  
**Bördelanschluss komplett**

Typ	Reference
<b>BO-A ... 1.4571</b>	Bestell-Nr.
BO-A 6 L-1.4571	WAL603919
BO-A 8 L-1.4571	WAL603920
BO-A 10 L-1.4571	WAL603921
BO-A 12 L-1.4571	WAL603922
BO-A 15 L-1.4571	WAL603923
BO-A 18 L-1.4571	WAL603924
BO-A 22 L-1.4571	WAL603925
BO-A 28 L-1.4571	WAL603926
BO-A 35 L-1.4571	WAL603927
BO-A 42 L-1.4571	WAL603928
BO-A 6 S-1.4571	WAL603929
BO-A 8 S-1.4571	WAL603930
BO-A 10 S-1.4571	WAL603931
BO-A 12 S-1.4571	WAL603932
BO-A 14 S-1.4571	WAL603933
BO-A 16 S-1.4571	WAL603934
BO-A 20 S-1.4571	WAL603935
BO-A 25 S-1.4571	WAL603936
BO-A 30 S-1.4571	WAL603937
BO-A 38 S-1.4571	WAL603938

**consisting of:**  
**bestehend aus:**

**Centre unit**  
**Zwischenring**



Typ	Reference
<b>BO-ZR ... 1.4571</b>	Bestell-Nr.
BO-ZR 6 L-1.4571	WAL602957
BO-ZR 8 L-1.4571	WAL602958
BO-ZR 10 L-1.4571	WAL602959
BO-ZR 12 L-1.4571	WAL602960
BO-ZR 15 L-1.4571	WAL602961
BO-ZR 18 L-1.4571	WAL602962
BO-ZR 22 L-1.4571	WAL602963
BO-ZR 28 L-1.4571	WAL602964
BO-ZR 35 L-1.4571	WAL602965
BO-ZR 42 L-1.4571	WAL602966
BO-ZR 6 S-1.4571	WAL602957
BO-ZR 8 S-1.4571	WAL602958
BO-ZR 10 S-1.4571	WAL602959
BO-ZR 12 S-1.4571	WAL602960
BO-ZR 14 S-1.4571	WAL602967
BO-ZR 16 S-1.4571	WAL602968
BO-ZR 20 S-1.4571	WAL602969
BO-ZR 25 S-1.4571	WAL602970
BO-ZR 30 S-1.4571	WAL602971
BO-ZR 38 S-1.4571	WAL602972

**Loose sleeve**  
**Druckring**



Typ	Reference
<b>BO-DR ... 1.4571</b>	Bestell-Nr.
BO-DR 6 L-1.4571	WAL602973
BO-DR 8 L-1.4571	WAL602974
BO-DR 10 L-1.4571	WAL602975
BO-DR 12 L-1.4571	WAL602976
BO-DR 15 L-1.4571	WAL602977
BO-DR 18 L-1.4571	WAL602978
BO-DR 22 L-1.4571	WAL602979
BO-DR 28 L-1.4571	WAL602980
BO-DR 35 L-1.4571	WAL602981
BO-DR 42 L-1.4571	WAL602982
BO-DR 6 S-1.4571	WAL602973
BO-DR 8 S-1.4571	WAL602974
BO-DR 10 S-1.4571	WAL602975
BO-DR 12 S-1.4571	WAL602976
BO-DR 14 S-1.4571	WAL602983
BO-DR 16 S-1.4571	WAL602984
BO-DR 20 S-1.4571	WAL602985
BO-DR 25 S-1.4571	WAL602986
BO-DR 30 S-1.4571	WAL602987
BO-DR 38 S-1.4571	WAL602988

**Nut**  
**Überwurfmutter**



Typ	Reference
<b>BO-M ... 1.4571</b>	Bestell-Nr.
BO-M 6 L-1.4571	WAL603901
BO-M 8 L-1.4571	WAL603902
BO-M 10 L-1.4571	WAL603903
BO-M 12 L-1.4571	WAL603904
BO-M 15 L-1.4571	WAL603905
BO-M 18 L-1.4571	WAL603906
BO-M 22 L-1.4571	WAL603907
BO-M 28 L-1.4571	WAL603908
BO-M 35 L-1.4571	WAL603909
BO-M 42 L-1.4571	WAL603910
BO-M 6 S-1.4571	WAL603911
BO-M 8 S-1.4571	WAL603912
BO-M 10 S-1.4571	WAL603913
BO-M 12 S-1.4571	WAL603914
BO-M 14 S-1.4571	WAL603905
BO-M 16 S-1.4571	WAL603915
BO-M 20 S-1.4571	WAL603907
BO-M 25 S-1.4571	WAL603916
BO-M 30 S-1.4571	WAL603917
BO-M 38 S-1.4571	WAL603918

**Male stud coupling**  
Stud thread: BSP thread (taper)  
metric (taper)



**Gerade-Einschraubverschraubung**  
Einschraubgewinde:  
Whitworth-Rohrgewinde (kegelig)  
Metrisches Gewinde (kegelig)

**Profile ring  
Profiling**

**Body only  
Stutzen**

Typ	Reference Bestell-Nr.
<b>P-GEV ... RK 1.4571-AGM</b>	
P-GEV 15 LRK - 1.4571-AGM	WAL621832

Typ	Reference Bestell-Nr.
<b>(S) P-GEV ... RK 1.4571</b>	
S-GEV 4 LLRK-1.4571	WAL604569
S-GEV 6 LLRK-1.4571	WAL060989
S-GEV 8 LLRK-1.4571	WAL370813
P-GEV 6 L/R 1/4 K-1.4571	WAL620527
P-GEV 8 LRK-1.4571	WAL620492
P-GEV 8 L/R 3/8 K-1.4571	WAL620539
P-GEV 10 LRK-1.4571	WAL620131
P-GEV 10 L/R 3/8 K-1.4571	WAL620132
P-GEV 12 LRK-1.4571	WAL620354
P-GEV 12 L/R 1/2 K-1.4571	WAL620553
P-GEV 12 L/R 1/4 K-1.4571	WAL620350
P-GEV 15 LRK-1.4571	WAL620357

Typ	Reference Bestell-Nr.
<b>GES ... RK 1.4571</b>	
GES 4 LLRK-1.4571	WAL604568
GES 6 LLRK-1.4571	WAL060990
GES 8 LLRK-1.4571	WAL061563
GES 6 L/R 1/4 K-1.4571	WAL372345
GES 8 LRK-1.4571	WAL604014
GES 8 L/R 3/8 K-1.4571	WAL605046
GES 10 LRK-1.4571	WAL060086
GES 10 L/R 3/8 K-1.4571	WAL060988
GES 12 LRK-1.4571	WAL372295
GES 12 L/R 1/2 K-1.4571	WAL374441
GES 12 L/R 1/4 K-1.4571	WAL372151
GES 15 LRK-1.4571	WAL068952

Typ	Reference Bestell-Nr.
<b>(S) P-GEV ... MK 1.4571</b>	
S-GEV 4 LLMK-1.4571	WAL617077
S-GEV 6 LLMK-1.4571	WAL616303
S-GEV 8 LLMK-1.4571	WAL616304
P-GEV 6 LM 12 x 1,5 K-1.4571	WAL620914
P-GEV 8 LMK-1.4571	WAL620514
P-GEV 8 LM 14 x 1,5 K-1.4571	WAL620915
P-GEV 10 LMK-1.4571	WAL621151
P-GEV 10 LM 16 x 1,5 K-1.4571	WAL620859
P-GEV 12 LMK-1.4571	WAL620916
P-GEV 12 LM 18 x 1,5 K-1.4571	WAL620917

Typ	Reference Bestell-Nr.
<b>GES ... MK 1.4571</b>	
GES 4 LLMK-1.4571	WAL617315
GES 6 LLMK-1.4571	WAL617316
GES 8 LLMK-1.4571	WAL061370
GES 6 LM 12 x 1,5 K-1.4571	WAL617317
GES 8 LMK-1.4571	WAL604888
GES 8 LM 14 x 1,5 K-1.4571	WAL617318
GES 10 LMK-1.4571	WAL617319
GES 10 LM 16 x 1,5 K-1.4571	WAL617320
GES 12 LMK-1.4571	WAL617321
GES 12 LM 18 x 1,5 K-1.4571	WAL617322

**Male stud coupling**  
Stud Thread: NPT

**Gerade-Einschraubverschraubung**  
Einschraubgewinde: NPT



Typ	Reference Bestell-Nr.
<b>P-GEV .. L .. NPT 1.4571-AGM</b>	

Typ	Reference Bestell-Nr.
<b>(S) P-GEV .. L .. NPT 1.4571</b>	
S-GEV 4 LL/ 1/8 NPT-1.4571	WAL616310
S-GEV 6 LL/ 1/8 NPT-1.4571	WAL602723
S-GEV 8 LL/ 1/8 NPT-1.4571	WAL371302
P-GEV 6 L/ 1/8 NPT-1.4571	WAL620123
P-GEV 6 L/ 1/4 NPT-1.4571	WAL620124
P-GEV 6 L/ 3/8 NPT-1.4571	WAL620619
P-GEV 8 L/ 1/8 NPT-1.4571	WAL620779
P-GEV 8 L/ 1/4 NPT-1.4571	WAL620128
P-GEV 8 L/ 3/8 NPT-1.4571	WAL620474
P-GEV 8 L/ 1/2 NPT-1.4571	WAL620186
P-GEV 10 L/ 1/8 NPT-1.4571	WAL620809
P-GEV 10 L/ 1/4 NPT-1.4571	WAL620147
P-GEV 10 L/ 3/8 NPT-1.4571	WAL620213
P-GEV 10 L/ 1/2 NPT-1.4571	WAL620780
P-GEV 10 L/ 3/4 NPT-1.4571	WAL620919
P-GEV 12 L/ 1/8 NPT-1.4571	WAL620920
P-GEV 12 L/ 1/4 NPT-1.4571	WAL620203
P-GEV 12 L/ 3/8 NPT-1.4571	WAL620210
P-GEV 12 L/ 1/2 NPT-1.4571	WAL620157
P-GEV 12 L/ 3/4 NPT-1.4571	WAL620921

Typ	Reference Bestell-Nr.
<b>GES .. L .. NPT 1.4571</b>	
GES 4 LL/ 1/8 NPT-1.4571	WAL617323
GES 6 LL/ 1/8 NPT-1.4571	WAL602722
GES 8 LL/ 1/8 NPT-1.4571	WAL371296
GES 6 L/ 1/8 NPT-1.4571	WAL060038
GES 6 L/ 1/4 NPT-1.4571	WAL060040
GES 6 L/ 3/8 NPT-1.4571	WAL060042
GES 8 L/ 1/8 NPT-1.4571	WAL617324
GES 8 L/ 1/4 NPT-1.4571	WAL060234
GES 8 L/ 3/8 NPT-1.4571	WAL604538
GES 8 L/ 1/2 NPT-1.4571	WAL024592
GES 10 L/ 1/8 NPT-1.4571	WAL617325
GES 10 L/ 1/4 NPT-1.4571	WAL061105
GES 10 L/ 3/8 NPT-1.4571	WAL066871
GES 10 L/ 1/2 NPT-1.4571	WAL066336
GES 10 L/ 3/4 NPT-1.4571	WAL617326
GES 12 L/ 1/8 NPT-1.4571	WAL617327
GES 12 L/ 1/4 NPT-1.4571	WAL061401
GES 12 L/ 3/8 NPT-1.4571	WAL060294
GES 12 L/ 1/2 NPT-1.4571	WAL061636
GES 12 L/ 3/4 NPT-1.4571	WAL617328

Typ	Reference
<b>P-GEV .. L .. NPT 1.4571-AGM</b>	<b>Bestell-Nr.</b>
P-GEV 15 L/ 3/8 NPT-1.4571-AGM	WAL624539
P-GEV 15 L/ 1/2 NPT-1.4571-AGM	WAL621755
P-GEV 15 L/ 3/4 NPT-1.4571-AGM	WAL622052
P-GEV 15 L/ 1 NPT-1.4571-AGM	WAL622053
P-GEV 18 L/ 3/8 NPT-1.4571-AGM	WAL622068
P-GEV 18 L/ 1/2 NPT-1.4571-AGM	WAL621734
P-GEV 18 L/ 3/4 NPT-1.4571-AGM	WAL622054
P-GEV 18 L/ 1 NPT-1.4571-AGM	WAL622055
P-GEV 22 L/ 3/8 NPT-1.4571-AGM	WAL622122
P-GEV 22 L/ 1/2 NPT-1.4571-AGM	WAL622056
P-GEV 22 L/ 3/4 NPT-1.4571-AGM	WAL621780
P-GEV 22 L/ 1 NPT-1.4571-AGM	WAL622123
P-GEV 28 L/ 3/4 NPT-1.4571-AGM	WAL622063
P-GEV 28 L/ 1 NPT-1.4571-AGM	WAL621781
P-GEV 28 L/ 1 1/4 NPT-1.4571-AGM	WAL622124
P-GEV 35 L/ 1 NPT-1.4571-AGM	WAL622125
P-GEV 35 L/ 1 1/4 NPT-1.4571-AGM	WAL621782
P-GEV 42 L/ 1 1/4 NPT-1.4571-AGM	WAL622126
P-GEV 42 L/ 1 1/2 NPT-1.4571-AGM	WAL621868

Typ	Reference
<b>(S) P-GEV .. L .. NPT 1.4571</b>	<b>Bestell-Nr.</b>
P-GEV 15 L/ 3/8 NPT-1.4571	WAL620922
P-GEV 15 L/ 1/2 NPT-1.4571	WAL620211
P-GEV 15 L/ 3/4 NPT-1.4571	WAL620781
P-GEV 15 L/ 1 NPT-1.4571	WAL620782
P-GEV 18 L/ 3/8 NPT-1.4571	WAL620810
P-GEV 18 L/ 1/2 NPT-1.4571	WAL620161
P-GEV 18 L/ 3/4 NPT-1.4571	WAL620783
P-GEV 18 L/ 1 NPT-1.4571	WAL620784
P-GEV 22 L/ 3/8 NPT-1.4571	WAL620923
P-GEV 22 L/ 1/2 NPT-1.4571	WAL620785
P-GEV 22 L/ 3/4 NPT-1.4571	WAL620260
P-GEV 22 L/ 1 NPT-1.4571	WAL620924
P-GEV 28 L/ 3/4 NPT-1.4571	WAL620799
P-GEV 28 L/ 1 NPT-1.4571	WAL620261
P-GEV 28 L/ 1 1/4 NPT-1.4571	WAL620925
P-GEV 35 L/ 1 NPT-1.4571	WAL620926
P-GEV 35 L/ 1 1/4 NPT-1.4571	WAL620262
P-GEV 42 L/ 1 1/4 NPT-1.4571	WAL620927
P-GEV 42 L/ 1 1/2 NPT-1.4571	WAL620422

Typ	Reference
<b>GES .. L .. NPT 1.4571</b>	<b>Bestell-Nr.</b>
GES 15 L/ 3/8 NPT-1.4571	WAL617329
GES 15 L/ 1/2 NPT-1.4571	WAL066642
GES 15 L/ 3/4 NPT-1.4571	WAL617330
GES 15 L/ 1 NPT-1.4571	WAL617331
GES 18 L/ 3/8 NPT-1.4571	WAL617332
GES 18 L/ 1/2 NPT-1.4571	WAL027537
GES 18 L/ 3/4 NPT-1.4571	WAL617333
GES 18 L/ 1 NPT-1.4571	WAL617334
GES 22 L/ 3/8 NPT-1.4571	WAL617335
GES 22 L/ 1/2 NPT-1.4571	WAL060247
GES 22 L/ 3/4 NPT-1.4571	WAL027539
GES 22 L/ 1 NPT-1.4571	WAL617336
GES 28 L/ 3/4 NPT-1.4571	WAL617337
GES 28 L/ 1 NPT-1.4571	WAL067862
GES 28 L/ 1 1/4 NPT-1.4571	WAL617338
GES 35 L/ 1 NPT-1.4571	WAL617339
GES 35 L/ 1 1/4 NPT-1.4571	WAL067863
GES 42 L/ 1 1/4 NPT-1.4571	WAL617340
GES 42 L/ 1 1/2 NPT-1.4571	WAL604136

**Male stud coupling**  
Stud thread: NPT

**Gerade-Einschraubverschraubung**  
Einschraubgewinde: NPT

Typ	Reference
<b>P-GEV .. S .. NPT 1.4571-AGM</b>	<b>Bestell-Nr.</b>
P-GEV 6 S/ 1/8 NPT-1.4571-AGM	WAL621994
P-GEV 6 S/ 3/8 NPT-1.4571-AGM	WAL621905
P-GEV 6 S/ 1/2 NPT-1.4571-AGM	WAL621797
P-GEV 6 S/ 3/4 NPT-1.4571-AGM	WAL622127
P-GEV 8 S/ 3/8 NPT-1.4571-AGM	WAL622461
P-GEV 8 S/ 1/2 NPT-1.4571-AGM	WAL622458
P-GEV 8 S/ 3/4 NPT-1.4571-AGM	WAL622460
P-GEV 8 S/ 1 NPT-1.4571-AGM	WAL622459
P-GEV 10 S/ 3/8 NPT-1.4571-AGM	WAL621980
P-GEV 10 S/ 1/2 NPT-1.4571-AGM	WAL621757
P-GEV 10 S/ 3/4 NPT-1.4571-AGM	WAL622057
P-GEV 10 S/ 1 NPT-1.4571-AGM	WAL622128
P-GEV 12 S/ 1/2 NPT-1.4571-AGM	WAL622129
P-GEV 12 S/ 3/4 NPT-1.4571-AGM	WAL621756
P-GEV 12 S/ 1 NPT-1.4571-AGM	WAL622130
P-GEV 14 S/ 1/2 NPT-1.4571-AGM	WAL622131
P-GEV 14 S/ 3/4 NPT-1.4571-AGM	WAL622132
P-GEV 14 S/ 1 NPT-1.4571-AGM	WAL621901
P-GEV 16 S/ 1 1/4 NPT-1.4571-AGM	WAL622133
P-GEV 16 S/ 1 1/2 NPT-1.4571-AGM	WAL622134
P-GEV 16 S/ 3/4 NPT-1.4571-AGM	WAL622135
P-GEV 16 S/ 1 NPT-1.4571-AGM	WAL622136
P-GEV 20 S/ 1 1/4 NPT-1.4571-AGM	WAL621909
P-GEV 20 S/ 1 1/2 NPT-1.4571-AGM	WAL622137
P-GEV 20 S/ 1 NPT-1.4571-AGM	WAL622138
P-GEV 20 S/ 1 1/4 NPT-1.4571-AGM	WAL622139
P-GEV 20 S/ 1 1/2 NPT-1.4571-AGM	WAL622140



**Profile ring**  
**Profilring**

Typ	Reference
<b>P-GEV .. S .. NPT 1.4571</b>	<b>Bestell-Nr.</b>
P-GEV 6 S/ 1/8 NPT-1.4571	WAL620928
P-GEV 6 S/ 1/4 NPT-1.4571	WAL620189
P-GEV 6 S/ 3/8 NPT-1.4571	WAL620929
P-GEV 6 S/ 1/2 NPT-1.4571	WAL620930
P-GEV 8 S/ 1/4 NPT-1.4571	WAL620523
P-GEV 8 S/ 3/8 NPT-1.4571	WAL620931
P-GEV 8 S/ 1/2 NPT-1.4571	WAL620932
P-GEV 10 S/ 1/4 NPT-1.4571	WAL620659
P-GEV 10 S/ 3/8 NPT-1.4571	WAL620370
P-GEV 10 S/ 1/2 NPT-1.4571	WAL620933
P-GEV 10 S/ 3/4 NPT-1.4571	WAL620934
P-GEV 12 S/ 1/4 NPT-1.4571	WAL620660
P-GEV 12 S/ 1/2 NPT-1.4571	WAL620491
P-GEV 12 S/ 3/8 NPT-1.4571	WAL620294
P-GEV 12 S/ 1/2 NPT-1.4571	WAL620935
P-GEV 14 S/ 3/8 NPT-1.4571	WAL621502
P-GEV 14 S/ 1/2 NPT-1.4571	WAL621499
P-GEV 14 S/ 3/4 NPT-1.4571	WAL621501
P-GEV 14 S/ 1 NPT-1.4571	WAL621500
P-GEV 16 S/ 3/8 NPT-1.4571	WAL620620
P-GEV 16 S/ 1/2 NPT-1.4571	WAL620214
P-GEV 16 S/ 3/4 NPT-1.4571	WAL620786
P-GEV 16 S/ 1 NPT-1.4571	WAL620936
P-GEV 20 S/ 1/2 NPT-1.4571	WAL620937
P-GEV 20 S/ 3/4 NPT-1.4571	WAL620212
P-GEV 20 S/ 1 NPT-1.4571	WAL620938
P-GEV 25 S/ 1/2 NPT-1.4571	WAL620939
P-GEV 25 S/ 3/4 NPT-1.4571	WAL620940
P-GEV 25 S/ 1 NPT-1.4571	WAL620482
P-GEV 25 S/ 1 1/4 NPT-1.4571	WAL620941
P-GEV 25 S/ 1 1/2 NPT-1.4571	WAL620942
P-GEV 30 S/ 3/4 NPT-1.4571	WAL620943
P-GEV 30 S/ 1 NPT-1.4571	WAL620944
P-GEV 30 S/ 1 1/4 NPT-1.4571	WAL620497
P-GEV 30 S/ 1 1/2 NPT-1.4571	WAL620945
P-GEV 38 S/ 1 NPT-1.4571	WAL620946
P-GEV 38 S/ 1 1/4 NPT-1.4571	WAL620947
P-GEV 38 S/ 1 1/2 NPT-1.4571	WAL620948

**Body only**  
**Stutzen**



Typ	Reference
<b>GES .. S .. NPT 1.4571</b>	<b>Bestell-Nr.</b>
GES 6 S/ 1/8 NPT-1.4571	WAL617341
GES 6 S/ 1/4 NPT-1.4571	WAL066587
GES 6 S/ 3/8 NPT-1.4571	WAL617342
GES 6 S/ 1/2 NPT-1.4571	WAL617343
GES 8 S/ 1/4 NPT-1.4571	WAL370917
GES 8 S/ 3/8 NPT-1.4571	WAL617344
GES 8 S/ 1/2 NPT-1.4571	WAL617345
GES 10 S/ 1/4 NPT-1.4571	WAL604274
GES 10 S/ 3/8 NPT-1.4571	WAL372983
GES 10 S/ 1/2 NPT-1.4571	WAL617346
GES 10 S/ 3/4 NPT-1.4571	WAL617347
GES 12 S/ 1/4 NPT-1.4571	WAL372802
GES 12 S/ 3/8 NPT-1.4571	WAL372822
GES 12 S/ 1/2 NPT-1.4571	WAL371154
GES 12 S/ 3/4 NPT-1.4571	WAL617348
GES 14 S/ 3/8 NPT-1.4571	WAL066338
GES 14 S/ 1/2 NPT-1.4571	WAL060715
GES 14 S/ 3/4 NPT-1.4571	WAL617349
GES 14 S/ 1 NPT-1.4571	WAL617350
GES 16 S/ 3/8 NPT-1.4571	WAL606265
GES 16 S/ 1/2 NPT-1.4571	WAL067067
GES 16 S/ 3/4 NPT-1.4571	WAL617351
GES 16 S/ 1 NPT-1.4571	WAL617352
GES 20 S/ 1/2 NPT-1.4571	WAL372271
GES 20 S/ 3/4 NPT-1.4571	WAL061817
GES 20 S/ 1 NPT-1.4571	WAL617353
GES 25 S/ 1/2 NPT-1.4571	WAL617354
GES 25 S/ 3/4 NPT-1.4571	WAL617355
GES 25 S/ 1 NPT-1.4571	WAL604630
GES 25 S/ 1 1/4 NPT-1.4571	WAL617356
GES 25 S/ 1 1/2 NPT-1.4571	WAL617357
GES 30 S/ 3/4 NPT-1.4571	WAL617358
GES 30 S/ 1 NPT-1.4571	WAL617359
GES 30 S/ 1 1/4 NPT-1.4571	WAL604724
GES 30 S/ 1 1/2 NPT-1.4571	WAL617360
GES 38 S/ 1 NPT-1.4571	WAL617361
GES 38 S/ 1 1/4 NPT-1.4571	WAL617362
GES 38 S/ 1 1/2 NPT-1.4571	WAL617363

**Male stud coupling**

Stud thread: BSP thread (parallel)  
stud face form B

**Gerade-Einschraubverschraubung**

Einschraubgewinde:  
Whitworth-Rohrgewinde (zylindrisch)  
Dichtkante Form B

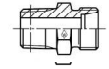

**Profile ring  
Profiling**

**Body only  
Stutzen**

Typ	Reference Bestell-Nr.
<b>P-GEV .. LR-1.4571-AGM</b>	
P-GEV 15 L/R 1/4-1.4571-AGM	WAL624532
P-GEV 15 L/R 3/8-1.4571-AGM	WAL621744
P-GEV 15 LR-1.4571-AGM	WAL621656
P-GEV 15 L/R 3/4-1.4571-AGM	WAL622095
P-GEV 18 L/R 3/8-1.4571-AGM	WAL622058
P-GEV 18 LR-1.4571-AGM	WAL621657
P-GEV 18 L/R 3/4-1.4571-AGM	WAL621894
P-GEV 22 L/R 1/2-1.4571-AGM	WAL621892
P-GEV 22 LR-1.4571-AGM	WAL621658
P-GEV 22 L/R 1-1.4571-AGM	WAL621893
P-GEV 28 L/R 1/2-1.4571-AGM	WAL624533
P-GEV 28 L/R 3/4-1.4571-AGM	WAL622059
P-GEV 28 LR-1.4571-AGM	WAL621659
P-GEV 28 L/R 1 1/4-1.4571-AGM	WAL622141
P-GEV 35 L/R 1/2-1.4571-AGM	WAL622142
P-GEV 35 L/R 3/4-1.4571-AGM	WAL622143
P-GEV 35 L/R 1-1.4571-AGM	WAL622144
P-GEV 35 LR-1.4571-AGM	WAL621660
P-GEV 35 L/R 1 1/2-1.4571-AGM	WAL622145
P-GEV 42 L/R 1-1.4571-AGM	WAL622146
P-GEV 42 L/R 1 1/4-1.4571-AGM	WAL622147
P-GEV 42 LR-1.4571-AGM	WAL621661

Typ (S) P-GEV .. LR-1.4571	Reference Bestell-Nr.
S-GEV 4 LLR-1.4571	WAL604717
S-GEV 6 LLR-1.4571	WAL061402
S-GEV 8 LLR-1.4571	WAL068993
P-GEV 6 LR-1.4571	WAL620004
P-GEV 6 L/R 1/4-1.4571	WAL620140
P-GEV 6 L/R 3/8-1.4571	WAL620269
P-GEV 6 L/R 1/2-1.4571	WAL620468
P-GEV 8 L/R 1/8-1.4571	WAL620633
P-GEV 8 LR-1.4571	WAL620005
P-GEV 8 L/R 3/8-1.4571	WAL620174
P-GEV 8 L/R 1/2-1.4571	WAL620312
P-GEV 10 L/R 1/8-1.4571	WAL620485
P-GEV 10 LR-1.4571	WAL620006
P-GEV 10 L/R 3/8-1.4571	WAL620003
P-GEV 10 L/R 1/2-1.4571	WAL620230
P-GEV 12 L/R 1/8-1.4571	WAL621498
P-GEV 12 L/R 1/4-1.4571	WAL620198
P-GEV 12 LR-1.4571	WAL620007
P-GEV 12 L/R 1/2-1.4571	WAL620148
P-GEV 15 L/R 1/4-1.4571	WAL620949
P-GEV 15 L/R 3/8-1.4571	WAL620191
P-GEV 15 LR-1.4571	WAL620008
P-GEV 15 L/R 3/4-1.4571	WAL620861
P-GEV 18 L/R 3/8-1.4571	WAL620787
P-GEV 18 LR-1.4571	WAL620009
P-GEV 18 L/R 3/4-1.4571	WAL620471
P-GEV 22 L/R 1/2-1.4571	WAL620469
P-GEV 22 LR-1.4571	WAL620010
P-GEV 22 L/R 1-1.4571	WAL620470
P-GEV 28 L/R 1/2-1.4571	WAL620950
P-GEV 28 L/R 3/4-1.4571	WAL620788
P-GEV 28 LR-1.4571	WAL620011
P-GEV 28 L/R 1 1/4-1.4571	WAL620951
P-GEV 35 L/R 1/2-1.4571	WAL620952
P-GEV 35 L/R 3/4-1.4571	WAL620953
P-GEV 35 L/R 1-1.4571	WAL620954
P-GEV 35 LR-1.4571	WAL620012
P-GEV 35 L/R 1 1/2-1.4571	WAL620955
P-GEV 42 L/R 1-1.4571	WAL620956
P-GEV 42 L/R 1 1/4-1.4571	WAL620957
P-GEV 42 LR-1.4571	WAL620013

Typ GES .. LR-1.4571	Reference Bestell-Nr.
GES 4 LLR-1.4571	WAL604716
GES 6 LLR-1.4571	WAL061403
GES 8 LLR-1.4571	WAL024261
GES 6 LR-1.4571	WAL025478
GES 6 L/R 1/4-1.4571	WAL061091
GES 6 L/R 3/8-1.4571	WAL617364
GES 6 L/R 1/2-1.4571	WAL604503
GES 8 L/R 1/8-1.4571	WAL024537
GES 8 LR-1.4571	WAL025479
GES 8 L/R 3/8-1.4571	WAL024175
GES 8 L/R 1/2-1.4571	WAL066137
GES 10 L/R 1/8-1.4571	WAL604684
GES 10 LR-1.4571	WAL025480
GES 10 L/R 3/8-1.4571	WAL024995
GES 10 L/R 1/2-1.4571	WAL066688
GES 12 L/R 1/8-1.4571	WAL617365
GES 12 L/R 1/4-1.4571	WAL024611
GES 12 LR-1.4571	WAL025481
GES 12 L/R 1/2-1.4571	WAL024613
GES 15 L/R 1/4-1.4571	WAL617366
GES 15 L/R 3/8-1.4571	WAL066617
GES 15 LR-1.4571	WAL025482
GES 15 L/R 3/4-1.4571	WAL613153
GES 18 L/R 3/8-1.4571	WAL617367
GES 18 LR-1.4571	WAL025483
GES 18 L/R 3/4-1.4571	WAL604521
GES 22 L/R 1/2-1.4571	WAL604504
GES 22 LR-1.4571	WAL025484
GES 22 L/R 1-1.4571	WAL604505
GES 28 L/R 1/2-1.4571	WAL617369
GES 28 L/R 3/4-1.4571	WAL615377
GES 28 LR-1.4571	WAL025485
GES 28 L/R 1 1/4-1.4571	WAL617370
GES 35 L/R 1/2-1.4571	WAL617371
GES 35 L/R 3/4-1.4571	WAL617372
GES 35 L/R 1-1.4571	WAL617373
GES 35 LR-1.4571	WAL025486
GES 35 L/R 1 1/2-1.4571	WAL617374
GES 42 L/R 1-1.4571	WAL617375
GES 42 L/R 1 1/4-1.4571	WAL617376
GES 42 LR-1.4571	WAL025487



**Male stud coupling**

Stud thread: BSP thread (parallel)  
stud face form B

**Gerade-Einschraubverschraubung**

Einschraubgewinde:  
Whitworth-Rohrgewinde (zylindrisch)  
Dichtkante Form B



**Profile ring  
Profiling**

**Body only  
Stutzen**

Typ	Reference Bestell-Nr.
<b>P-GEV .. SR-1.4571-AGM</b>	
P-GEV 12 S/R 1/4-1.4571-AGM	WAL621830
P-GEV 12 SR-1.4571-AGM	WAL621662
P-GEV 12 S/R 1/2-1.4571-AGM	WAL621721
P-GEV 12 S/R 3/4-1.4571-AGM	WAL622148
P-GEV 14 S/R 1/4-1.4571-AGM	WAL622462
P-GEV 14 S/R 3/8-1.4571-AGM	WAL622467
P-GEV 14 SR-1.4571-AGM	WAL622471
P-GEV 14 S/R 3/4-1.4571-AGM	WAL622465
P-GEV 14 S/R 1-1.4571-AGM	WAL622464
P-GEV 16 S/R 3/8-1.4571-AGM	WAL621829
P-GEV 16 SR-1.4571-AGM	WAL621663
P-GEV 16 S/R 3/4-1.4571-AGM	WAL622060
P-GEV 20 S/R 1/2-1.4571-AGM	WAL621751
P-GEV 20 SR-1.4571-AGM	WAL621664
P-GEV 20 S/R 1-1.4571-AGM	WAL621976
P-GEV 20 S/R 1 1/4-1.4571-AGM	WAL622149
P-GEV 20 S/R 1 1/2-1.4571-AGM	WAL622150
P-GEV 25 S/R 1/2-1.4571-AGM	WAL622151
P-GEV 25 S/R 3/4-1.4571-AGM	WAL621973
P-GEV 25 SR-1.4571-AGM	WAL621665
P-GEV 25 S/R 1 1/4-1.4571-AGM	WAL622152
P-GEV 25 S/R 1 1/2-1.4571-AGM	WAL622153
P-GEV 30 S/R 1-1.4571-AGM	WAL622154
P-GEV 30 SR-1.4571-AGM	WAL621666
P-GEV 30 S/R 1 1/2-1.4571-AGM	WAL622155
P-GEV 38 S/R 1 1/4-1.4571-AGM	WAL621984
P-GEV 38 SR-1.4571-AGM	WAL621667

Typ	Reference Bestell-Nr.
<b>P-GEV .. SR-1.4571</b>	
P-GEV 6 S/R 1/8-1.4571	WAL620958
P-GEV 6 SR-1.4571	WAL620014
P-GEV 6 S/R 3/8-1.4571	WAL620776
P-GEV 6 S/R 1/2-1.4571	WAL620777
P-GEV 6 S/R 3/4-1.4571	WAL620959
P-GEV 8 SR-1.4571	WAL620015
P-GEV 8 S/R 3/8-1.4571	WAL620811
P-GEV 8 S/R 1/2-1.4571	WAL620960
P-GEV 10 S/R 1/4-1.4571	WAL620295
P-GEV 10 SR-1.4571	WAL620016
P-GEV 10 S/R 1/2-1.4571	WAL620224
P-GEV 12 S/R 1/4-1.4571	WAL620353
P-GEV 12 SR-1.4571	WAL620017
P-GEV 12 S/R 1/2-1.4571	WAL620120
P-GEV 12 S/R 3/4-1.4571	WAL620961
P-GEV 14 S/R 1/4-1.4571	WAL621503
P-GEV 14 S/R 3/8-1.4571	WAL621508
P-GEV 14 SR-1.4571	WAL621512
P-GEV 14 S/R 3/4-1.4571	WAL621506
P-GEV 14 S/R 1-1.4571	WAL621505
P-GEV 16 S/R 3/8-1.4571	WAL620352
P-GEV 16 SR-1.4571	WAL620018
P-GEV 16 S/R 3/4-1.4571	WAL620789
P-GEV 20 S/R 1/2-1.4571	WAL620202
P-GEV 20 SR-1.4571	WAL620019
P-GEV 20 S/R 1-1.4571	WAL620614
P-GEV 20 S/R 1 1/4-1.4571	WAL620962
P-GEV 20 S/R 1 1/2-1.4571	WAL620963
P-GEV 25 S/R 1/2-1.4571	WAL620964
P-GEV 25 S/R 3/4-1.4571	WAL620606
P-GEV 25 SR-1.4571	WAL620020
P-GEV 25 S/R 1 1/4-1.4571	WAL620965
P-GEV 25 S/R 1 1/2-1.4571	WAL620966
P-GEV 30 S/R 1-1.4571	WAL620967
P-GEV 30 SR-1.4571	WAL620021
P-GEV 30 S/R 1 1/2-1.4571	WAL620968
P-GEV 38 S/R 1 1/4-1.4571	WAL620630
P-GEV 38 SR-1.4571	WAL620022

Typ	Reference Bestell-Nr.
<b>GES .. SR-1.4571</b>	
GES 6 S/R 1/8-1.4571	WAL617377
GES 6 SR-1.4571	WAL025488
GES 6 S/R 3/8-1.4571	WAL617378
GES 6 S/R 1/2-1.4571	WAL617379
GES 6 S/R 3/4-1.4571	WAL617380
GES 8 SR-1.4571	WAL025489
GES 8 S/R 3/8-1.4571	WAL617381
GES 8 S/R 1/2-1.4571	WAL617382
GES 10 S/R 1/4-1.4571	WAL067084
GES 10 SR-1.4571	WAL025490
GES 10 S/R 1/2-1.4571	WAL066872
GES 12 S/R 1/4-1.4571	WAL617383
GES 12 SR-1.4571	WAL025491
GES 12 S/R 1/2-1.4571	WAL060015
GES 12 S/R 3/4-1.4571	WAL617384
GES 14 S/R 1/4-1.4571	WAL617385
GES 14 S/R 3/8-1.4571	WAL604696
GES 14 SR-1.4571	WAL025492
GES 14 S/R 3/4-1.4571	WAL617386
GES 14 S/R 1-1.4571	WAL617387
GES 16 S/R 3/8-1.4571	WAL372245
GES 16 SR-1.4571	WAL025493
GES 16 S/R 3/4-1.4571	WAL617388
GES 20 S/R 1/2-1.4571	WAL066306
GES 20 SR-1.4571	WAL025494
GES 20 S/R 1-1.4571	WAL605914
GES 20 S/R 1 1/4-1.4571	WAL617389
GES 20 S/R 1 1/2-1.4571	WAL617390
GES 25 S/R 1/2-1.4571	WAL617391
GES 25 S/R 3/4-1.4571	WAL605636
GES 25 SR-1.4571	WAL025495
GES 25 S/R 1 1/4-1.4571	WAL617392
GES 25 S/R 1 1/2-1.4571	WAL617393
GES 30 S/R 1-1.4571	WAL617394
GES 30 SR-1.4571	WAL025496
GES 30 S/R 1 1/2-1.4571	WAL617395
GES 38 S/R 1 1/4-1.4571	WAL606647
GES 38 SR-1.4571	WAL025497

**Male stud coupling**  
Stud thread: metric (parallel)  
stud face form B

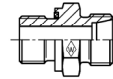

**Gerade-Einschraubverschraubung**  
Einschraubgewinde:  
Metrisches Gewinde (zylindrisch)  
Dichtkante Form B

**Profile ring  
Profiling**

**Body only  
Stutzen**

Typ	Reference Bestell-Nr.
<b>P-GEV .. LM-1.4571-AGM</b>	
P-GEV 15 LM-1.4571-AGM	WAL621668
P-GEV 15 LM 22 x 1,5-1.4571-AGM	WAL623100
P-GEV 18 LM-1.4571-AGM	WAL621669
P-GEV 18 LM 18 x 1,5-1.4571-AGM	WAL623101
P-GEV 22 LM-1.4571-AGM	WAL621870
P-GEV 28 LM-1.4571-AGM	WAL621670
P-GEV 35 LM-1.4571-AGM	WAL621883
P-GEV 42 LM-1.4571-AGM	WAL622169
P-GEV 12 SM-1.4571-AGM	WAL621671
P-GEV 14 SM-1.4571-AGM	WAL622469
P-GEV 16 SM-1.4571-AGM	WAL621995
P-GEV 20 SM-1.4571-AGM	WAL621911
P-GEV 25 SM-1.4571-AGM	WAL622108
P-GEV 30 SM-1.4571-AGM	WAL622277
P-GEV 38 SM-1.4571-AGM	WAL621996

Typ (S) P-GEV .. LM-1.4571	Reference Bestell-Nr.
S-GEV 4 LLM-1.4571	WAL623050
S-GEV 6 LLM-1.4571	WAL623052
S-GEV 8 LLM-1.4571	WAL371486
P-GEV 6 LM-1.4571	WAL620023
P-GEV 6 LM 12 x 1,5-1.4571	WAL623054
P-GEV 8 LM-1.4571	WAL620024
P-GEV 8 LM 18 x 1,5-1.4571	WAL623056
P-GEV 10 LM-1.4571	WAL620025
P-GEV 10 LM 16 x 1,5-1.4571	WAL623057
P-GEV 10 LM 18 x 1,5-1.4571	WAL623059
P-GEV 10 LM 22 x 1,5-1.4571	WAL623060
P-GEV 12 LM-1.4571	WAL620026
P-GEV 12 LM 18 x 1,5-1.4571	WAL623062
P-GEV 12 LM 22 x 1,5-1.4571	WAL623063
P-GEV 15 LM-1.4571	WAL620027
P-GEV 15 LM 22 x 1,5-1.4571	WAL620816
P-GEV 18 LM-1.4571	WAL620028
P-GEV 18 LM 18 x 1,5-1.4571	WAL623065
P-GEV 22 LM-1.4571	WAL620424
P-GEV 28 LM-1.4571	WAL620029
P-GEV 35 LM-1.4571	WAL620452
P-GEV 42 LM-1.4571	WAL620995
P-GEV 6 SM-1.4571	WAL620030
P-GEV 8 SM-1.4571	WAL620031
P-GEV 10 SM-1.4571	WAL620032
P-GEV 12 SM-1.4571	WAL620033
P-GEV 14 SM-1.4571	WAL621510
P-GEV 16 SM-1.4571	WAL620661
P-GEV 20 SM-1.4571	WAL620503
P-GEV 25 SM-1.4571	WAL620887
P-GEV 30 SM-1.4571	WAL621150
P-GEV 38 SM-1.4571	WAL620662

Typ GES .. LM-1.4571	Reference Bestell-Nr.
GES 4 LLM-1.4571	WAL623051
GES 6 LLM-1.4571	WAL623053
GES 8 LLM-1.4571	WAL371485
GES 6 LM-1.4571	WAL025498
GES 6 LM 12 x 1,5-1.4571	WAL623055
GES 8 LM-1.4571	WAL025499
GES 8 LM 18 x 1,5-1.4571	WAL372571
GES 10 LM-1.4571	WAL025500
GES 10 LM 16 x 1,5-1.4571	WAL623058
GES 10 LM 18 x 1,5-1.4571	WAL372883
GES 10 LM 22 x 1,5-1.4571	WAL623061
GES 12 LM-1.4571	WAL025501
GES 12 LM 18 x 1,5-1.4571	WAL602783
GES 12 LM 22 x 1,5-1.4571	WAL623064
GES 15 LM-1.4571	WAL025502
GES 15 LM 22 x 1,5-1.4571	WAL604968
GES 18 LM-1.4571	WAL025503
GES 18 LM 18 x 1,5-1.4571	WAL623066
GES 22 LM-1.4571	WAL604218
GES 28 LM-1.4571	WAL025505
GES 35 LM-1.4571	WAL025506
GES 42 LM-1.4571	WAL617435
GES 6 SM-1.4571	WAL028656
GES 8 SM-1.4571	WAL025508
GES 10 SM-1.4571	WAL025509
P-GEV 12 SM-1.4571	WAL025510
P-GEV 14 SM-1.4571	WAL025511
P-GEV 16 SM-1.4571	WAL025512
P-GEV 20 SM-1.4571	WAL025513
P-GEV 25 SM-1.4571	WAL025514
P-GEV 30 SM-1.4571	WAL617436
P-GEV 38 SM-1.4571	WAL025516

**Male stud coupling**  
with captive seal  
Stud thread: BSP thread (parallel)  
**Gerade-Einschraubverschraubung**  
mit Weichdichtung  
Einschraubgewinde:  
Whitworth-Rohrgewinde (zylindrisch)



**Profile ring  
Profiling**

**Body only  
Stutzen**

Typ	Reference Bestell-Nr.
<b>P-GEV .. LR-WD-VI-1.4571-AGM</b>	

Typ P-GEV .. LR-WD-VI-1.4571	Reference Bestell-Nr.
P-GEV 6 LR-WD-VI-1.4571	WAL620444
P-GEV 6 L/R 1/4-WD-VI-1.4571	WAL620754
P-GEV 6 L/R 3/8-WD-VI-1.4571	WAL620969
P-GEV 6 L/R 1/2-WD-VI-1.4571	WAL620970
P-GEV 8 L/R 1/8-WD-VI-1.4571	WAL620971
P-GEV 8 LR-WD-VI-1.4571	WAL620509
P-GEV 8 L/R 3/8-WD-VI-1.4571	WAL620907
P-GEV 8 L/R 1/2-WD-VI-1.4571	WAL620972
P-GEV 10 L/R 1/8-WD-VI-1.4571	WAL620973
P-GEV 10 LR-WD-VI-1.4571	WAL620437
P-GEV 10 L/R 3/8-WD-VI-1.4571	WAL620752
P-GEV 10 L/R 1/2-WD-VI-1.4571	WAL620753
P-GEV 12 L/R 1/8-WD-VI-1.4571	WAL620974
P-GEV 12 L/R 1/4-WD-VI-1.4571	WAL620592
P-GEV 12 LR-WD-VI-1.4571	WAL620561
P-GEV 12 L/R 1/2-WD-VI-1.4571	WAL620761

Typ GES .. LR-WD-VI-1.4571	Reference Bestell-Nr.
GES 6 LR-WD-VI-1.4571	WAL602810
GES 6 L/R 1/4-WD-VI-1.4571	WAL617396
GES 6 L/R 3/8-WD-VI-1.4571	WAL617397
GES 6 L/R 1/2-WD-VI-1.4571	WAL617398
GES 8 L/R 1/8-WD-VI-1.4571	WAL617399
GES 8 LR-WD-VI-1.4571	WAL602768
GES 8 L/R 3/8-WD-VI-1.4571	WAL617400
GES 8 L/R 1/2-WD-VI-1.4571	WAL617401
GES 10 L/R 1/8-WD-VI-1.4571	WAL617402
GES 10 LR-WD-VI-1.4571	WAL371729
GES 10 L/R 3/8-WD-VI-1.4571	WAL617403
GES 10 L/R 1/2-WD-VI-1.4571	WAL617404
GES 12 L/R 1/8-WD-VI-1.4571	WAL617405
GES 12 L/R 1/4-WD-VI-1.4571	WAL605376
GES 12 LR-WD-VI-1.4571	WAL371730
GES 12 L/R 1/2-WD-VI-1.4571	WAL615260

Typ	Reference
<b>P-GEV .. LR-WD-VI-1.4571-AGM</b>	Bestell-Nr.
P-GEV 15 L/R 1/4-WD-VI-1.4571-AGM	WAL622156
P-GEV 15 LR-WD-VI-1.4571-AGM	WAL621887
P-GEV 15 L/R 3/8-WD-VI-1.4571-AGM	WAL622091
P-GEV 15 L/R 3/4-WD-VI-1.4571-AGM	WAL622104
P-GEV 18 L/R 3/8-WD-VI-1.4571-AGM	WAL622157
P-GEV 18 LR-WD-VI-1.4571-AGM	WAL621878
P-GEV 18 L/R 3/4-WD-VI-1.4571-AGM	WAL622158
P-GEV 22 L/R 1/2-WD-VI-1.4571-AGM	WAL622159
P-GEV 22 LR-WD-VI-1.4571-AGM	WAL621879
P-GEV 22 L/R 1-WD-VI-1.4571-AGM	WAL622160
P-GEV 28 L/R 1/2-WD-VI-1.4571-AGM	WAL622161
P-GEV 28 L/R 3/4-WD-VI-1.4571-AGM	WAL622452
P-GEV 28 LR-WD-VI-1.4571-AGM	WAL621880
P-GEV 28 L/R 1 1/4-WD-VI-1.4571-AGM	WAL622162
P-GEV 35 L/R 1/2-WD-VI-1.4571-AGM	WAL622092
P-GEV 35 L/R 3/4-WD-VI-1.4571-AGM	WAL622093
P-GEV 35 L/R 1-WD-VI-1.4571-AGM	WAL622163
P-GEV 35 LR-WD-VI-1.4571-AGM	WAL621941
P-GEV 35 L/R 1 1/2-WD-VI-1.4571-AGM	WAL622115
P-GEV 42 L/R 1-WD-VI-1.4571-AGM	WAL622164
P-GEV 42 L/R 1 1/4-WD-VI-1.4571-AGM	WAL622165
P-GEV 42 LR-WD-VI-1.4571-AGM	WAL621967

**Male stud coupling**  
with captive seal  
Stud thread: BSP thread (parallel)  
**Gerade-Einschraubverschraubung**  
mit Weichdichtung  
Einschraubgewinde:  
Whitworth-Rohrgewinde (zylindrisch)



**Profile ring  
Profiling**

Typ	Reference
<b>P-GEV .. SR-WD-VI-1.4571-AGM</b>	Bestell-Nr.
P-GEV 12 S/R 1/4-WD-VI-1.4571-AGM	WAL621990
P-GEV 12 SR-WD-VI-1.4571-AGM	WAL621899
P-GEV 12 S/R 1/2-WD-VI-1.4571-AGM	WAL622076
P-GEV 12 S/R 3/4-WD-VI-1.4571-AGM	WAL622166
P-GEV 14 S/R 1/4-WD-VI-1.4571-AGM	WAL622463
P-GEV 14 S/R 3/8-WD-VI-1.4571-AGM	WAL622468
P-GEV 14 SR-WD-VI-1.4571-AGM	WAL622472
P-GEV 14 S/R 3/4-WD-VI-1.4571-AGM	WAL622466
P-GEV 16 S/R 3/8-WD-VI-1.4571-AGM	WAL622061
P-GEV 16 SR-WD-VI-1.4571-AGM	WAL621944
P-GEV 16 S/R 3/4-WD-VI-1.4571-AGM	WAL622167
P-GEV 20 S/R 1/2-WD-VI-1.4571-AGM	WAL622072
P-GEV 20 SR-WD-VI-1.4571-AGM	WAL621989
P-GEV 20 S/R 1-WD-VI-1.4571-AGM	WAL622453
P-GEV 20 S/R 1 1/4-WD-VI-1.4571-AGM	WAL624534
P-GEV 20 S/R 1 1/2-WD-VI-1.4571-AGM	WAL624535
P-GEV 25 S/R 1/2-WD-VI-1.4571-AGM	WAL622073
P-GEV 25 S/R 3/4-WD-VI-1.4571-AGM	WAL621992
P-GEV 25 SR-WD-VI-1.4571-AGM	WAL621969
P-GEV 25 S/R 1 1/4-WD-VI-1.4571-AGM	WAL622079
P-GEV 25 S/R 1 1/2-WD-VI-1.4571-AGM	WAL622080
P-GEV 30 S/R 1-WD-VI-1.4571-AGM	WAL622086
P-GEV 30 SR-WD-VI-1.4571-AGM	WAL621991
P-GEV 30 S/R 1 1/2-WD-VI-1.4571-AGM	WAL622168
P-GEV 38 S/R 1 1/4-WD-VI-1.4571-AGM	WAL622081
P-GEV 38 SR-WD-VI-1.4571-AGM	WAL621979

Typ	Reference
<b>P-GEV .. SR-WD-VI-1.4571</b>	Bestell-Nr.
P-GEV 6 S/R 1/8-WD-VI-1.4571	WAL621147
P-GEV 6 SR-WD-VI-1.4571	WAL620445
P-GEV 6 S/R 3/8-WD-VI-1.4571	WAL620985
P-GEV 6 S/R 1/2-WD-VI-1.4571	WAL620986
P-GEV 6 S/R 3/4-WD-VI-1.4571	WAL620987
P-GEV 8 SR-WD-VI-1.4571	WAL620763
P-GEV 8 S/R 3/8-WD-VI-1.4571	WAL620988
P-GEV 8 S/R 1/2-WD-VI-1.4571	WAL620989
P-GEV 10 S/R 1/4-WD-VI-1.4571	WAL620644
P-GEV 10 SR-WD-VI-1.4571	WAL620567
P-GEV 10 S/R 1/2-WD-VI-1.4571	WAL620822
P-GEV 12 S/R 1/4-WD-VI-1.4571	WAL620645
P-GEV 12 SR-WD-VI-1.4571	WAL620478
P-GEV 12 S/R 1/2-WD-VI-1.4571	WAL620828
P-GEV 12 S/R 3/4-WD-VI-1.4571	WAL620990
P-GEV 14 S/R 1/4-WD-VI-1.4571	WAL621504
P-GEV 14 S/R 3/8-WD-VI-1.4571	WAL621509
P-GEV 14 SR-WD-VI-1.4571	WAL621513
P-GEV 14 S/R 3/4-WD-VI-1.4571	WAL621507
P-GEV 16 S/R 3/8-WD-VI-1.4571	WAL620795
P-GEV 16 SR-WD-VI-1.4571	WAL620562
P-GEV 16 S/R 3/4-WD-VI-1.4571	WAL620991
P-GEV 20 S/R 1/2-WD-VI-1.4571	WAL620824
P-GEV 20 SR-WD-VI-1.4571	WAL620643
P-GEV 20 S/R 1-WD-VI-1.4571	WAL621457
P-GEV 20 S/R 1 1/4-WD-VI-1.4571	WAL620992
P-GEV 20 S/R 1 1/2-WD-VI-1.4571	WAL620993
P-GEV 25 S/R 1/2-WD-VI-1.4571	WAL620825
P-GEV 25 S/R 3/4-WD-VI-1.4571	WAL620647
P-GEV 25 SR-WD-VI-1.4571	WAL620598
P-GEV 25 S/R 1 1/4-WD-VI-1.4571	WAL620836
P-GEV 25 S/R 1 1/2-WD-VI-1.4571	WAL620837
P-GEV 30 S/R 1-WD-VI-1.4571	WAL620846
P-GEV 30 SR-WD-VI-1.4571	WAL620646
P-GEV 30 S/R 1 1/2-WD-VI-1.4571	WAL620994
P-GEV 38 S/R 1 1/4-WD-VI-1.4571	WAL620838
P-GEV 38 SR-WD-VI-1.4571	WAL620617

Typ	Reference
<b>GES .. LR-WD-VI-1.4571</b>	Bestell-Nr.
GES 15 L/R 1/4-WD-VI-1.4571	WAL618652
GES 15 LR-WD-VI-1.4571	WAL371731
GES 15 L/R 3/8-WD-VI-1.4571	WAL610673
GES 15 L/R 3/4-WD-VI-1.4571	WAL617406
GES 18 L/R 3/8-WD-VI-1.4571	WAL617407
GES 18 LR-WD-VI-1.4571	WAL371732
GES 18 L/R 3/4-WD-VI-1.4571	WAL613147
GES 22 L/R 1/2-WD-VI-1.4571	WAL615605
GES 22 LR-WD-VI-1.4571	WAL371733
GES 22 L/R 1-WD-VI-1.4571	WAL615401
GES 28 L/R 1/2-WD-VI-1.4571	WAL617408
GES 28 L/R 3/4-WD-VI-1.4571	WAL615516
GES 28 LR-WD-VI-1.4571	WAL371734
GES 28 L/R 1 1/4-WD-VI-1.4571	WAL617409
GES 35 L/R 1/2-WD-VI-1.4571	WAL617410
GES 35 L/R 3/4-WD-VI-1.4571	WAL617411
GES 35 L/R 1-WD-VI-1.4571	WAL617412
GES 35 LR-WD-VI-1.4571	WAL605252
GES 35 L/R 1 1/2-WD-VI-1.4571	WAL615787
GES 42 L/R 1-WD-VI-1.4571	WAL617413
GES 42 L/R 1 1/4-WD-VI-1.4571	WAL617414
GES 42 LR-WD-VI-1.4571	WAL605379

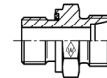

**Body only  
Stutzen**

Typ	Reference
<b>GES .. SR-WD-VI-1.4571</b>	Bestell-Nr.
GES 6 S/R 1/8-WD-VI-1.4571	WAL617415
GES 6 SR-WD-VI-1.4571	WAL605280
GES 6 S/R 3/8-WD-VI-1.4571	WAL617416
GES 6 S/R 1/2-WD-VI-1.4571	WAL617417
GES 6 S/R 3/4-WD-VI-1.4571	WAL617418
GES 8 SR-WD-VI-1.4571	WAL604432
GES 8 S/R 3/8-WD-VI-1.4571	WAL617419
GES 8 S/R 1/2-WD-VI-1.4571	WAL617420
GES 10 S/R 1/4-WD-VI-1.4571	WAL605271
GES 10 SR-WD-VI-1.4571	WAL605325
GES 10 S/R 1/2-WD-VI-1.4571	WAL617421
GES 12 S/R 1/4-WD-VI-1.4571	WAL613333
GES 12 SR-WD-VI-1.4571	WAL602918
GES 12 S/R 1/2-WD-VI-1.4571	WAL613283
GES 12 S/R 3/4-WD-VI-1.4571	WAL617422
GES 14 S/R 1/4-WD-VI-1.4571	WAL617423
GES 14 S/R 3/8-WD-VI-1.4571	WAL617424
GES 14 SR-WD-VI-1.4571	WAL605299
GES 14 S/R 3/4-WD-VI-1.4571	WAL617425
GES 16 S/R 3/8-WD-VI-1.4571	WAL613275
GES 16 SR-WD-VI-1.4571	WAL604607
GES 16 S/R 3/4-WD-VI-1.4571	WAL605330
GES 20 S/R 1/2-WD-VI-1.4571	WAL615698
GES 20 SR-WD-VI-1.4571	WAL605677
GES 20 S/R 1-WD-VI-1.4571	WAL617426
GES 20 S/R 1 1/4-WD-VI-1.4571	WAL617427
GES 20 S/R 1 1/2-WD-VI-1.4571	WAL617428
GES 25 S/R 1/2-WD-VI-1.4571	WAL617429
GES 25 S/R 3/4-WD-VI-1.4571	WAL617430
GES 25 SR-WD-VI-1.4571	WAL606245
GES 25 S/R 1 1/4-WD-VI-1.4571	WAL615515
GES 25 S/R 1 1/2-WD-VI-1.4571	WAL617431
GES 30 S/R 1-WD-VI-1.4571	WAL617432
GES 30 SR-WD-VI-1.4571	WAL605678
GES 30 S/R 1 1/2-WD-VI-1.4571	WAL617433
GES 38 S/R 1 1/4-WD-VI-1.4571	WAL617434
GES 38 SR-WD-VI-1.4571	WAL604606



**Male stud elbow**

Stud thread: metric (taper)



**Winkel-Einschraubverschraubung**

Einschraubgewinde:  
Metrisches Gewinde (kegelig)

**Profile ring  
Profiling**

**Body only  
Stutzen**



Typ	Reference Bestell-Nr.	Typ (S) P-WEV .. MK-1.4571	Reference Bestell-Nr.	Typ	Reference Bestell-Nr.
<b>P-WEV ... MK-1.4571-AGM</b>				<b>WES .. MK-1.4571</b>	
		S-WEV 4 LLMK-1.4571	WAL616402	WES 4 LLMK-1.4571	WAL067181
		S-WEV 6 LLMK-1.4571	WAL609041	WES 6 LLMK-1.4571	WAL606649
		S-WEV 8 LLMK-1.4571	WAL616403	WES 8 LLMK-1.4571	WAL617441
		P-WEV 6 LMK-1.4571	WAL620050	WES 6 LMK-1.4571	WAL025537
		P-WEV 8 LMK-1.4571	WAL620610	WES 8 LMK-1.4571	WAL025538
		P-WEV 10 LMK-1.4571	WAL620999	WES 10 LMK-1.4571	WAL025539
		P-WEV 12 LMK-1.4571	WAL620051	WES 12 LMK-1.4571	WAL025540
P-WEV 15 LMK-1.4571-AGM	WAL621681	P-WEV 15 LMK-1.4571	WAL620052	WES 15 LMK-1.4571	WAL025541
P-WEV 18 LMK-1.4571-AGM	WAL621682	P-WEV 18 LMK-1.4571	WAL620053	WES 18 LMK-1.4571	WAL025542
		P-WEV 6 SMK-1.4571	WAL621000	WES 6 SMK-1.4571	WAL025543
		P-WEV 8 SMK-1.4571	WAL620665	WES 8 SMK-1.4571	WAL025544
		P-WEV 10 SMK-1.4571	WAL620666	WES 10 SMK-1.4571	WAL025545
P-WEV 12 SMK-1.4571-AGM	WAL621998	P-WEV 12 SMK-1.4571	WAL620667	WES 12 SMK-1.4571	WAL025546
P-WEV 14 SMK-1.4571-AGM	WAL622482	P-WEV 14 SMK-1.4571	WAL621647	WES 14 SMK-1.4571	WAL025547
P-WEV 16 SMK-1.4571-AGM	WAL622172	P-WEV 16 SMK-1.4571	WAL621001	WES 16 SMK-1.4571	WAL025548

**Male stud elbow**

Stud thread: NPT



**Winkel-Einschraubverschraubung**

Einschraubgewinde: NPT

**Profile ring  
Profiling**

**Body only  
Stutzen**



Typ	Reference Bestell-Nr.	Typ (S) P-WEV .. NPT-1.4571	Reference Bestell-Nr.	Typ	Reference Bestell-Nr.
<b>P-WEV ... NPT-1.4571-AGM</b>				<b>WES .. NPT-1.4571</b>	
		S-WEV 4 LL/ 1/8 NPT-1.4571	WAL616408	WES 4 LL/ 1/8 NPT-1.4571	WAL617442
		S-WEV 6 LL/ 1/8 NPT-1.4571	WAL608456	WES 6 LL/ 1/8 NPT-1.4571	WAL024144
		S-WEV 8 LL/ 1/8 NPT-1.4571	WAL607142	WES 8 LL/ 1/8 NPT-1.4571	WAL617443
		P-WEV 6 L/ 1/8 NPT-1.4571	WAL620499	WES 6 L/ 1/8 NPT-1.4571	WAL604782
		P-WEV 8 L/ 1/4 NPT-1.4571	WAL620187	WES 8 L/ 1/4 NPT-1.4571	WAL066342
		P-WEV 10 L/ 1/4 NPT-1.4571	WAL620188	WES 10 L/ 1/4 NPT-1.4571	WAL060075
		P-WEV 12 L/ 1/4 NPT-1.4571	WAL620215	WES 12 L/ 1/4 NPT-1.4571	WAL067069
		P-WEV 12 L/ 3/8 NPT-1.4571	WAL620257	WES 12 L/ 3/8 NPT-1.4571	WAL067678
P-WEV 15 L/ 1/2 NPT-1.4571-AGM	WAL621778	P-WEV 15 L/ 1/2 NPT-1.4571	WAL620258	WES 15 L/ 1/2 NPT-1.4571	WAL067682
P-WEV 18 L/ 1/2 NPT-1.4571-AGM	WAL621727	P-WEV 18 L/ 1/2 NPT-1.4571	WAL620134	WES 18 L/ 1/2 NPT-1.4571	WAL027535
P-WEV 22 L/ 3/4 NPT-1.4571-AGM	WAL622173	P-WEV 22 L/ 3/4 NPT-1.4571	WAL621002	WES 22 L/ 3/4 NPT-1.4571	WAL069030
P-WEV 28 L/ 1 NPT-1.4571-AGM	WAL622174	P-WEV 28 L/ 1 NPT-1.4571	WAL621003	WES 28 L/ 1 NPT-1.4571	WAL604436
		P-WEV 6 S/ 1/4 NPT-1.4571	WAL620484	WES 6 S/ 1/4 NPT-1.4571	WAL604307
		P-WEV 8 S/ 1/4 NPT-1.4571	WAL620501	WES 8 S/ 1/4 NPT-1.4571	WAL604712
		P-WEV 10 S/ 3/8 NPT-1.4571	WAL620750	WES 10 S/ 3/8 NPT-1.4571	WAL605048
P-WEV 12 S/ 3/8 NPT-1.4571-AGM	WAL621837	P-WEV 12 S/ 3/8 NPT-1.4571	WAL620366	WES 12 S/ 3/8 NPT-1.4571	WAL372649
P-WEV 14 S/ 1/2 NPT-1.4571-AGM	WAL622481	P-WEV 14 S/ 1/2 NPT-1.4571	WAL621646	WES 14 S/ 1/2 NPT-1.4571	WAL067071
P-WEV 16 S/ 1/2 NPT-1.4571-AGM	WAL621997	P-WEV 16 S/ 1/2 NPT-1.4571	WAL620663	WES 16 S/ 1/2 NPT-1.4571	WAL605049
P-WEV 20 S/ 3/4 NPT-1.4571-AGM	WAL621758	P-WEV 20 S/ 3/4 NPT-1.4571	WAL620216	WES 20 S/ 3/4 NPT-1.4571	WAL067073
P-WEV 25 S/ 1 NPT-1.4571-AGM	WAL622175	P-WEV 25 S/ 1 NPT-1.4571	WAL621004	WES 25 S/ 1 NPT-1.4571	WAL617444





Equal cross

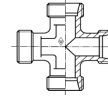

Kreuz-Verschraubung

Typ	Reference Bestell-Nr.
<b>P-KV ... -1.4571-AGM</b>	
P-KV 15 L-1.4571-AGM	WAL621831
P-KV 18 L-1.4571-AGM	WAL622000
P-KV 22 L-1.4571-AGM	WAL621928
P-KV 28 L-1.4571-AGM	WAL622198
P-KV 35 L-1.4571-AGM	WAL622199
P-KV 42 L-1.4571-AGM	WAL622001
P-KV 12 S-1.4571-AGM	WAL621924
P-KV 14 S-1.4571-AGM	WAL622474
P-KV 16 S-1.4571-AGM	WAL622200
P-KV 20 S-1.4571-AGM	WAL622120
P-KV 25 S-1.4571-AGM	WAL621918
P-KV 30 S-1.4571-AGM	WAL622201
P-KV 38 S-1.4571-AGM	WAL622202

Profile ring  
Profiling

Typ <b>(S) P-KV ... -1.4571</b>	Reference Bestell-Nr.
S-KV 4 LL-1.4571	WAL623076
S-KV 6 LL-1.4571	WAL623078
S-KV 8 LL-1.4571	WAL623080
P-KV 6 L-1.4571	WAL620368
P-KV 8 L-1.4571	WAL621030
P-KV 10 L-1.4571	WAL620446
P-KV 12 L-1.4571	WAL620442
P-KV 15 L-1.4571	WAL620355
P-KV 18 L-1.4571	WAL620670
P-KV 22 L-1.4571	WAL620529
P-KV 28 L-1.4571	WAL621031
P-KV 35 L-1.4571	WAL621032
P-KV 42 L-1.4571	WAL620671
P-KV 6 S-1.4571	WAL621033
P-KV 8 S-1.4571	WAL620649
P-KV 10 S-1.4571	WAL620498
P-KV 12 S-1.4571	WAL620522
P-KV 14 S-1.4571	WAL621534
P-KV 16 S-1.4571	WAL621034
P-KV 20 S-1.4571	WAL620906
P-KV 25 S-1.4571	WAL620515
P-KV 30 S-1.4571	WAL621035
P-KV 38 S-1.4571	WAL621036

Body only  
Stutzen

Typ <b>KS ... -1.4571</b>	Reference Bestell-Nr.
KS 4 LL-1.4571	WAL623077
KS 6 LL-1.4571	WAL623079
KS 8 LL-1.4571	WAL623081
KS 6 L-1.4571	WAL372737
KS 8 L-1.4571	WAL372105
KS 10 L-1.4571	WAL370719
KS 12 L-1.4571	WAL604343
KS 15 L-1.4571	WAL372319
KS 18 L-1.4571	WAL374733
KS 22 L-1.4571	WAL371815
KS 28 L-1.4571	WAL617474
KS 35 L-1.4571	WAL617475
KS 42 L-1.4571	WAL605168
KS 6 S-1.4571	WAL617476
KS 8 S-1.4571	WAL617477
KS 10 S-1.4571	WAL604780
KS 12 S-1.4571	WAL604969
KS 14 S-1.4571	WAL617478
KS 16 S-1.4571	WAL371676
KS 20 S-1.4571	WAL617479
KS 25 S-1.4571	WAL604892
KS 30 S-1.4571	WAL371178
KS 38 S-1.4571	WAL604807



**Straight bulkhead coupling**  
with hexagon nut

**Gerade-Schottverschraubung**  
mit Sechskantmutter

Typ	Reference Bestell-Nr.
<b>P-GSV ... -1.4571-AGM</b>	
P-GSV 15 L m. 6kt M-1.4571-AGM	WAL621759
P-GSV 18 L m. 6kt M-1.4571-AGM	WAL621747
P-GSV 22 L m. 6kt M-1.4571-AGM	WAL621748
P-GSV 28 L m. 6kt M-1.4571-AGM	WAL621745
P-GSV 35 L m. 6kt M-1.4571-AGM	WAL621917
P-GSV 42 L m. 6kt M-1.4571-AGM	WAL621785
P-GSV 12 S m. 6kt M-1.4571-AGM	WAL621728
P-GSV 14 S m. 6kt M-1.4571-AGM	WAL621890
P-GSV 16 S m. 6kt M-1.4571-AGM	WAL621735
P-GSV 20 S m. 6kt M-1.4571-AGM	WAL621765
P-GSV 25 S m. 6kt M-1.4571-AGM	WAL621746
P-GSV 30 S m. 6kt M-1.4571-AGM	WAL621779
P-GSV 38 S m. 6kt M-1.4571-AGM	WAL621846

**Bulkhead elbow coupling**  
with hexagon nut

**Winkel-Schottverschraubung**  
mit Sechskantmutter

Typ	Reference Bestell-Nr.
<b>P-WSV ... -1.4571-AGM</b>	
P-WSV 15 L m. 6kt M-1.4571-AGM	WAL621821
P-WSV 18 L m. 6kt M-1.4571-AGM	WAL621910
P-WSV 22 L m. 6kt M-1.4571-AGM	WAL621923
P-WSV 28 L m. 6kt M-1.4571-AGM	WAL621936
P-WSV 35 L m. 6kt M-1.4571-AGM	WAL622002
P-WSV 42 L m. 6kt M-1.4571-AGM	WAL622003
P-WSV 12 S m. 6kt M-1.4571-AGM	WAL621818
P-WSV 14 S m. 6kt M-1.4571-AGM	WAL622004
P-WSV 16 S m. 6kt M-1.4571-AGM	WAL621783
P-WSV 20 S m. 6kt M-1.4571-AGM	WAL621762
P-WSV 25 S m. 6kt M-1.4571-AGM	WAL621773
P-WSV 30 S m. 6kt M-1.4571-AGM	WAL622005
P-WSV 38 S m. 6kt M-1.4571-AGM	WAL621845

**Hexagon nut**  
for bulkhead coupling and bulkhead body only

**Sechskantmutter**  
für Schottverschraubung / -stutzen

Hexagon Nut 1.4571 Sechskantmutter 1.4571	Reference Bestell-Nr.
SKM M 12x1,5-1.4571 (for/für 6 L)	WAL035964
SKM M 14x1,5-1.4571 (for/für 8 L+6 S)	WAL035660
SKM M 16x1,5-1.4571 (for/für 10 L+8 S)	WAL035965
SKM M 18x1,5-1.4571 (for/für 12 L+10 S)	WAL029341
SKM M 22x1,5-1.4571 (for/für 15 L+14 S)	WAL035966
SKM M 26x1,5-1.4571 (for/für 18 L)	WAL029344
SKM M 30x2-1.4571 (for/für 22 L+20 S)	WAL029345
SKM M 36x2-1.4571 (for/für 28 L+25 S)	WAL035968
SKM M 45x2-1.4571 (for/für 35 L)	WAL029347
SKM M 52x2-1.4571 (for/für 42 L+38 S)	WAL029349



**Profile ring  
Profiling**

Typ	Reference Bestell-Nr.
<b>P-GSV ... -1.4571</b>	
P-GSV 6 L m. 6kt M-1.4571	WAL620175
P-GSV 8 L m. 6kt M-1.4571	WAL620154
P-GSV 10 L m. 6kt M-1.4571	WAL620143
P-GSV 12 L m. 6kt M-1.4571	WAL620137
P-GSV 15 L m. 6kt M-1.4571	WAL620217
P-GSV 18 L m. 6kt M-1.4571	WAL620194
P-GSV 22 L m. 6kt M-1.4571	WAL620195
P-GSV 28 L m. 6kt M-1.4571	WAL620192
P-GSV 35 L m. 6kt M-1.4571	WAL620513
P-GSV 42 L m. 6kt M-1.4571	WAL620267
P-GSV 6 S m. 6kt M-1.4571	WAL620135
P-GSV 8 S m. 6kt M-1.4571	WAL620273
P-GSV 10 S m. 6kt M-1.4571	WAL620206
P-GSV 12 S m. 6kt M-1.4571	WAL620136
P-GSV 14 S m. 6kt M-1.4571	WAL620466
P-GSV 16 S m. 6kt M-1.4571	WAL620162
P-GSV 20 S m. 6kt M-1.4571	WAL620234
P-GSV 25 S m. 6kt M-1.4571	WAL620193
P-GSV 30 S m. 6kt M-1.4571	WAL620259
P-GSV 38 S m. 6kt M-1.4571	WAL620392



**Profile ring  
Profiling**

Typ	Reference Bestell-Nr.
<b>P-WSV ... -1.4571</b>	
P-WSV 6 L m. 6kt M-1.4571	WAL620245
P-WSV 8 L m. 6kt M-1.4571	WAL620480
P-WSV 10 L m. 6kt M-1.4571	WAL620502
P-WSV 12 L m. 6kt M-1.4571	WAL620246
P-WSV 15 L m. 6kt M-1.4571	WAL620338
P-WSV 18 L m. 6kt M-1.4571	WAL620500
P-WSV 22 L m. 6kt M-1.4571	WAL620520
P-WSV 28 L m. 6kt M-1.4571	WAL620552
P-WSV 35 L m. 6kt M-1.4571	WAL620672
P-WSV 42 L m. 6kt M-1.4571	WAL620673
P-WSV 6 S m. 6kt M-1.4571	WAL620540
P-WSV 8 S m. 6kt M-1.4571	WAL620541
P-WSV 10 S m. 6kt M-1.4571	WAL620463
P-WSV 12 S m. 6kt M-1.4571	WAL620334
P-WSV 14 S m. 6kt M-1.4571	WAL620674
P-WSV 16 S m. 6kt M-1.4571	WAL620264
P-WSV 20 S m. 6kt M-1.4571	WAL620223
P-WSV 25 S m. 6kt M-1.4571	WAL620247
P-WSV 30 S m. 6kt M-1.4571	WAL620675
P-WSV 38 S m. 6kt M-1.4571	WAL620391

**For spare part need**

**Für Ersatzteilbedarf**

Hexagon Nut 1.4571 Sechskantmutter 1.4571	Reference Bestell-Nr.
SKM M 14x1,5-1.4571 (for/für 8 L+6 S)	WAL035660
SKM M 16x1,5-1.4571 (for/für 10 L+8 S)	WAL035965
SKM M 18x1,5-1.4571 (for/für 12 L+10 S)	WAL029341
SKM M 20x1,5-1.4571 (for/für 12 S)	WAL029342
SKM M 22x1,5-1.4571 (for/für 15 L+14 S)	WAL035966
SKM M 24x1,5-1.4571 (for/für 16 S)	WAL035967
SKM M 30x2-1.4571 (for/für 22 L+20 S)	WAL029345
SKM M 36x2-1.4571 (for/für 28 L+25 S)	WAL035968
SKM M 42x2-1.4571 (for/für 30 S)	WAL029346
SKM M 52x2-1.4571 (for/für 42 L+38 S)	WAL029349

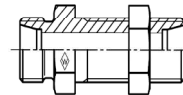

**Body only  
Stutzen**

Typ	Reference Bestell-Nr.
<b>GSS ... m. 6kt M-1.4571</b>	
GSS 6 L m. 6kt M-1.4571	WAL606286
GSS 8 L m. 6kt M-1.4571	WAL606287
GSS 10 L m. 6kt M-1.4571	WAL606288
GSS 12 L m. 6kt M-1.4571	WAL602786
GSS 15 L m. 6kt M-1.4571	WAL617480
GSS 18 L m. 6kt M-1.4571	WAL605445
GSS 22 L m. 6kt M-1.4571	WAL612436
GSS 28 L m. 6kt M-1.4571	WAL617481
GSS 35 L m. 6kt M-1.4571	WAL617482
GSS 42 L m. 6kt M-1.4571	WAL617483
GSS 6 S m. 6kt M-1.4571	WAL603960
GSS 8 S m. 6kt M-1.4571	WAL604963
GSS 10 S m. 6kt M-1.4571	WAL617063
GSS 12 S m. 6kt M-1.4571	WAL604599
GSS 14 S m. 6kt M-1.4571	WAL617484
GSS 16 S m. 6kt M-1.4571	WAL372243
GSS 20 S m. 6kt M-1.4571	WAL370731
GSS 25 S m. 6kt M-1.4571	WAL372244
GSS 30 S m. 6kt M-1.4571	WAL617485
GSS 38 S m. 6kt M-1.4571	WAL604964

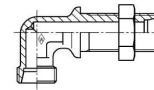

**Body only  
Stutzen**

Typ	Reference Bestell-Nr.
<b>WSS ... m. 6kt M-1.4571</b>	
WSS 6 L m. 6kt M-1.4571	WAL617488
WSS 8 L m. 6kt M-1.4571	WAL617489
WSS 10 L m. 6kt M-1.4571	WAL608422
WSS 12 L m. 6kt M-1.4571	WAL615355
WSS 15 L m. 6kt M-1.4571	WAL617490
WSS 18 L m. 6kt M-1.4571	WAL617491
WSS 22 L m. 6kt M-1.4571	WAL612437
WSS 28 L m. 6kt M-1.4571	WAL615221
WSS 35 L m. 6kt M-1.4571	WAL617492
WSS 42 L m. 6kt M-1.4571	WAL617493
WSS 6 S m. 6kt M-1.4571	WAL617494
WSS 8 S m. 6kt M-1.4571	WAL617495
WSS 10 S m. 6kt M-1.4571	WAL617496
WSS 12 S m. 6kt M-1.4571	WAL617497
WSS 14 S m. 6kt M-1.4571	WAL617498
WSS 16 S m. 6kt M-1.4571	WAL601079
WSS 20 S m. 6kt M-1.4571	WAL612438
WSS 25 S m. 6kt M-1.4571	WAL615212
WSS 30 S m. 6kt M-1.4571	WAL615651
WSS 38 S m. 6kt M-1.4571	WAL617499







**Adjustable male stud elbow**  
standpipe with pre-assembled nut and profile ring



**Einstellbare Winkel-Verschraubung**  
mit Schaft vormontiert

Typ	Reference Bestell-Nr.
<b>P-EWV ... -SV-1.4571-AGM</b>	
P-EWV 6 L-SV-1.4571-AGM	WAL621823
P-EWV 8 L-SV-1.4571-AGM	WAL621915
P-EWV 10 L-SV-1.4571-AGM	WAL621790
P-EWV 12 L-SV-1.4571-AGM	WAL621820
P-EWV 15 L-SV-1.4571-AGM	WAL621823
P-EWV 18 L-SV-1.4571-AGM	WAL621915
P-EWV 22 L-SV-1.4571-AGM	WAL621790
P-EWV 28 L-SV-1.4571-AGM	WAL621820
P-EWV 6 S-SV-1.4571-AGM	WAL620330
P-EWV 8 S-SV-1.4571-AGM	WAL620465
P-EWV 10 S-SV-1.4571-AGM	WAL620319
P-EWV 12 S-SV-1.4571-AGM	WAL620320
P-EWV 14 S-SV-1.4571-AGM	WAL620542
P-EWV 16 S-SV-1.4571-AGM	WAL620248

**Profile ring  
Profilingring**

Typ	Reference Bestell-Nr.
<b>P-EWV ... SV-1.4571</b>	
P-EWV 6 L-SV-1.4571	WAL620232
P-EWV 8 L-SV-1.4571	WAL620372
P-EWV 10 L-SV-1.4571	WAL620268
P-EWV 12 L-SV-1.4571	WAL620226
P-EWV 15 L-SV-1.4571	WAL620340
P-EWV 18 L-SV-1.4571	WAL620508
P-EWV 22 L-SV-1.4571	WAL620280
P-EWV 28 L-SV-1.4571	WAL620337
P-EWV 6 S-SV-1.4571	WAL620330
P-EWV 8 S-SV-1.4571	WAL620465
P-EWV 10 S-SV-1.4571	WAL620319
P-EWV 12 S-SV-1.4571	WAL620320
P-EWV 14 S-SV-1.4571	WAL620542
P-EWV 16 S-SV-1.4571	WAL620248

**Body only  
Stutzen**



Typ	Reference Bestell-Nr.
<b>P-EWS ... SV-1.4571</b>	
P-EWS 6 L-SV-1.4571	WAL621226
P-EWS 8 L-SV-1.4571	WAL621227
P-EWS 10 L-SV-1.4571	WAL620332
P-EWS 12 L-SV-1.4571	WAL620651
P-EWS 15 L-SV-1.4571	WAL620604
P-EWS 18 L-SV-1.4571	WAL620336
P-EWS 22 L-SV-1.4571	WAL620380
P-EWS 28 L-SV-1.4571	WAL621228
P-EWS 6 S-SV-1.4571	WAL620594
P-EWS 8 S-SV-1.4571	WAL620655
P-EWS 10 S-SV-1.4571	WAL621230
P-EWS 12 S-SV-1.4571	WAL621231
P-EWS 14 S-SV-1.4571	WAL621232
P-EWS 16 S-SV-1.4571	WAL620321

**Adjustable male stud elbow**  
with taper and O-ring



**Einstellbare Winkel-Verschraubung**  
mit Dichtkegel und O-Ring

Typ	Reference Bestell-Nr.
<b>P-EWVD ... -VI-1.4571-AGM</b>	
P-EWVD 6 L-VI-1.4571-AGM	WAL622389
P-EWVD 8 L-VI-1.4571-AGM	WAL622390
P-EWVD 10 L-VI-1.4571-AGM	WAL622391
P-EWVD 12 L-VI-1.4571-AGM	WAL622392
P-EWVD 15 L-VI-1.4571-AGM	WAL622393
P-EWVD 18 L-VI-1.4571-AGM	WAL622394
P-EWVD 6 S-VI-1.4571-AGM	WAL621966
P-EWVD 8 S-VI-1.4571-AGM	WAL622395
P-EWVD 10 S-VI-1.4571-AGM	WAL622396
P-EWVD 12 S-VI-1.4571-AGM	WAL622397
P-EWVD 14 S-VI-1.4571-AGM	WAL622398
P-EWVD 16 S-VI-1.4571-AGM	WAL622399
P-EWVD 20 S-VI-1.4571-AGM	WAL622400

**Profile ring  
Profilingring**

Typ	Reference Bestell-Nr.
<b>P-EWVD ... VI-1.4571</b>	
P-EWVD 6 L-VI-1.4571	WAL621326
P-EWVD 8 L-VI-1.4571	WAL621327
P-EWVD 10 L-VI-1.4571	WAL621328
P-EWVD 12 L-VI-1.4571	WAL621329
P-EWVD 15 L-VI-1.4571	WAL621330
P-EWVD 18 L-VI-1.4571	WAL621331
P-EWVD 22 L-VI-1.4571	WAL621332
P-EWVD 28 L-VI-1.4571	WAL621333
P-EWVD 35 L-VI-1.4571	WAL621334
P-EWVD 42 L-VI-1.4571	WAL621335
P-EWVD 6 S-VI-1.4571	WAL621336
P-EWVD 8 S-VI-1.4571	WAL621337
P-EWVD 10 S-VI-1.4571	WAL621338
P-EWVD 12 S-VI-1.4571	WAL620589
P-EWVD 14 S-VI-1.4571	WAL621339
P-EWVD 16 S-VI-1.4571	WAL621340
P-EWVD 20 S-VI-1.4571	WAL621341
P-EWVD 25 S-VI-1.4571	WAL621342
P-EWVD 30 S-VI-1.4571	WAL621343
P-EWVD 38 S-VI-1.4571	WAL621344

**Body only  
Stutzen**

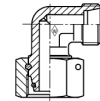

Typ	Reference Bestell-Nr.
<b>EWSD ... VI-1.4571</b>	
EWSD 6 L-VI-1.4571	WAL618224
EWSD 8 L-VI-1.4571	WAL618225
EWSD 10 L-VI-1.4571	WAL618226
EWSD 12 L-VI-1.4571	WAL618227
EWSD 15 L-VI-1.4571	WAL618228
EWSD 18 L-VI-1.4571	WAL618229
EWSD 22 L-VI-1.4571	WAL618230
EWSD 28 L-VI-1.4571	WAL618231
EWSD 35 L-VI-1.4571	WAL618232
EWSD 42 L-VI-1.4571	WAL618233
EWSD 6 S-VI-1.4571	WAL618234
EWSD 8 S-VI-1.4571	WAL618235
EWSD 10 S-VI-1.4571	WAL618236
EWSD 12 S-VI-1.4571	WAL605365
EWSD 14 S-VI-1.4571	WAL606246
EWSD 16 S-VI-1.4571	WAL618237
EWSD 20 S-VI-1.4571	WAL067826
EWSD 25 S-VI-1.4571	WAL606247
EWSD 30 S-VI-1.4571	WAL606248
EWSD 38 S-VI-1.4571	WAL618238

**Adjustable equal Tee**  
standpipe with pre-assembled nut and profile ring

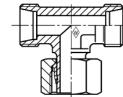

**Einstellbare T-Verschraubung**  
mit Schaft vormontiert

**Profile ring  
Profiling**

**Body only  
Stutzen**

Typ	Reference Bestell-Nr.
<b>P-ETV ... -SV-1.4571-AGM</b>	
P-ETV 15 L-SV-1.4571-AGM	WAL621916
P-ETV 18 L-SV-1.4571-AGM	WAL622010
P-ETV 22 L-SV-1.4571-AGM	WAL622011
P-ETV 28 L-SV-1.4571-AGM	WAL622012
P-ETV 12 S-SV-1.4571-AGM	WAL621865
P-ETV 14 S-SV-1.4571-AGM	WAL622243
P-ETV 16 S-SV-1.4571-AGM	WAL622013

Typ	Reference Bestell-Nr.
<b>P-ETV ... SV-1.4571</b>	
P-ETV 6 L-SV-1.4571	WAL620329
P-ETV 8 L-SV-1.4571	WAL620341
P-ETV 10 L-SV-1.4571	WAL620436
P-ETV 12 L-SV-1.4571	WAL620486
P-ETV 15 L-SV-1.4571	WAL620512
P-ETV 18 L-SV-1.4571	WAL620686
P-ETV 22 L-SV-1.4571	WAL620687
P-ETV 28 L-SV-1.4571	WAL620688
P-ETV 6 S-SV-1.4571	WAL620689
P-ETV 8 S-SV-1.4571	WAL621096
P-ETV 10 S-SV-1.4571	WAL620690
P-ETV 12 S-SV-1.4571	WAL620419
P-ETV 14 S-SV-1.4571	WAL621097
P-ETV 16 S-SV-1.4571	WAL620691

Typ	Reference Bestell-Nr.
<b>P-ETS ... SV-1.4571</b>	
P-ETS 6 L-SV-1.4571	WAL621235
P-ETS 8 L-SV-1.4571	WAL621236
P-ETS 10 L-SV-1.4571	WAL620654
P-ETS 12 L-SV-1.4571	WAL620333
P-ETS 15 L-SV-1.4571	WAL621237
P-ETS 18 L-SV-1.4571	WAL621238
P-ETS 22 L-SV-1.4571	WAL621239
P-ETS 28 L-SV-1.4571	WAL621240
P-ETS 6 S-SV-1.4571	WAL621243
P-ETS 8 S-SV-1.4571	WAL621244
P-ETS 10 S-SV-1.4571	WAL621245
P-ETS 12 S-SV-1.4571	WAL621246
P-ETS 14 S-SV-1.4571	WAL621247
P-ETS 16 S-SV-1.4571	WAL621248

**Adjustable equal Tee**  
with taper and O-ring

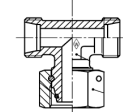

**Einstellbare T-Verschraubung**  
mit Dichtkegel und O-Ring

**Profile ring  
Profiling**

**Body only  
Stutzen**

Typ	Reference Bestell-Nr.
<b>P-ETVD ... -VI-1.4571-AGM</b>	
P-ETVD 15 L-VI-1.4571-AGM	WAL622401
P-ETVD 18 L-VI-1.4571-AGM	WAL622246
P-ETVD 22 L-VI-1.4571-AGM	WAL622247
P-ETVD 28 L-VI-1.4571-AGM	WAL622402
P-ETVD 35 L-VI-1.4571-AGM	WAL622403
P-ETVD 42 L-VI-1.4571-AGM	WAL622404
P-ETVD 12 S-VI-1.4571-AGM	WAL621986
P-ETVD 14 S-VI-1.4571-AGM	WAL622248
P-ETVD 16 S-VI-1.4571-AGM	WAL622405
P-ETVD 20 S-VI-1.4571-AGM	WAL622406
P-ETVD 25 S-VI-1.4571-AGM	WAL622407
P-ETVD 30 S-VI-1.4571-AGM	WAL622408
P-ETVD 38 S-VI-1.4571-AGM	WAL622409

Typ	Reference Bestell-Nr.
<b>P-ETVD ... VI-1.4571</b>	
P-ETVD 6 L-VI-1.4571	WAL621345
P-ETVD 8 L-VI-1.4571	WAL621100
P-ETVD 10 L-VI-1.4571	WAL621346
P-ETVD 12 L-VI-1.4571	WAL621347
P-ETVD 15 L-VI-1.4571	WAL621348
P-ETVD 18 L-VI-1.4571	WAL621101
P-ETVD 22 L-VI-1.4571	WAL621102
P-ETVD 28 L-VI-1.4571	WAL621349
P-ETVD 35 L-VI-1.4571	WAL621350
P-ETVD 42 L-VI-1.4571	WAL621351
P-ETVD 6 S-VI-1.4571	WAL621103
P-ETVD 8 S-VI-1.4571	WAL621352
P-ETVD 10 S-VI-1.4571	WAL621353
P-ETVD 12 S-VI-1.4571	WAL620637
P-ETVD 14 S-VI-1.4571	WAL621104
P-ETVD 16 S-VI-1.4571	WAL621354
P-ETVD 20 S-VI-1.4571	WAL621355
P-ETVD 25 S-VI-1.4571	WAL621356
P-ETVD 30 S-VI-1.4571	WAL621357
P-ETVD 38 S-VI-1.4571	WAL621358

Typ	Reference Bestell-Nr.
<b>ETSD ... VI-1.4571</b>	
ETSD 6 L-VI-1.4571	WAL618253
ETSD 8 L-VI-1.4571	WAL618254
ETSD 10 L-VI-1.4571	WAL618255
ETSD 12 L-VI-1.4571	WAL618256
ETSD 15 L-VI-1.4571	WAL618257
ETSD 18 L-VI-1.4571	WAL618258
ETSD 22 L-VI-1.4571	WAL618259
ETSD 28 L-VI-1.4571	WAL618260
ETSD 35 L-VI-1.4571	WAL618261
ETSD 42 L-VI-1.4571	WAL617598
ETSD 6 S-VI-1.4571	WAL617599
ETSD 8 S-VI-1.4571	WAL618262
ETSD 10 S-VI-1.4571	WAL618263
ETSD 12 S-VI-1.4571	WAL618264
ETSD 14 S-VI-1.4571	WAL606249
ETSD 16 S-VI-1.4571	WAL618265
ETSD 20 S-VI-1.4571	WAL618266
ETSD 25 S-VI-1.4571	WAL618267
ETSD 30 S-VI-1.4571	WAL617600
ETSD 38 S-VI-1.4571	WAL618268



**Stud standpipe adaptor (body only)**

standpipe with pre-assembled nut and profile ring and captive seal  
Stud thread: BSP thread (parallel)

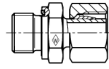

**Gerade Einschraubstutzen**

mit Schaft vormontiert und Weichdichtung  
Einschraubgewinde: Whitworth-Rohrgewinde (zylindrisch)

Typ	Reference Bestell-Nr.
<b>P-EGES ... R-WD-VI-SV-1.4571-AGM</b>	
P-EGES 6 LR-WD-VI-SV-1.4571-AGM	WAL621884
P-EGES 8 LR-WD-VI-SV-1.4571-AGM	WAL623098
P-EGES 10 LR-WD-VI-SV-1.4571-AGM	WAL621902
P-EGES 12 LR-WD-VI-SV-1.4571-AGM	WAL621895
P-EGES 15 LR-WD-VI-SV-1.4571-AGM	WAL621856
P-EGES 12 S/R 1/2-WD-VI-SV-1.4571-AGM	WAL623099
P-EGES 14 SR-WD-VI-SV-1.4571-AGM	WAL622457
P-EGES 16 SR-WD-VI-SV-1.4571-AGM	WAL621931
P-EGES 16 S/R 3/4-WD-VI-SV-1.4571-AGM	WAL623162

**Stud standpipe adaptor (body only)**

standpipe with pre-assembled nut and profile ring and captive seal  
Stud thread: BSP thread (parallel)

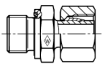

**Gerade Einschraubstutzen**

mit Schaft vormontiert und Weichdichtung  
Einschraubgewinde: Whitworth-Rohrgewinde (zylindrisch)

Typ	Reference Bestell-Nr.
<b>P-EGES ... M-WD-VI-SV-1.4571-AGM</b>	
P-EGES 6 LM-WD-VI-SV-1.4571-AGM	WAL622257
P-EGES 8 LM-WD-VI-SV-1.4571-AGM	WAL622258
P-EGES 10 LM-WD-VI-SV-1.4571-AGM	WAL622259
P-EGES 12 LM-WD-VI-SV-1.4571-AGM	WAL622263
P-EGES 14 SM-WD-VI-SV-1.4571-AGM	WAL622456
P-EGES 16 SM-WD-VI-SV-1.4571-AGM	WAL621993

Typ	Reference Bestell-Nr.
<b>P-EGES ... R-WD-VI-SV-1.4571</b>	
P-EGES 6 LR-WD-VI-SV-1.4571	WAL620543
P-EGES 8 LR-WD-VI-SV-1.4571	WAL620493
P-EGES 10 LR-WD-VI-SV-1.4571	WAL620456
P-EGES 12 LR-WD-VI-SV-1.4571	WAL620408
P-EGES 12 L/R 1/4-WD-VI-SV-1.4571	WAL623088
P-EGES 15 LR-WD-VI-SV-1.4571	WAL620457
P-EGES 15 L/R 3/8-WD-VI-SV-1.4571	WAL623089
P-EGES 18 LR-WD-VI-SV-1.4571	WAL620487
P-EGES 22 LR-WD-VI-SV-1.4571	WAL620472
P-EGES 6 SR-WD-VI-SV-1.4571	WAL620544
P-EGES 8 SR-WD-VI-SV-1.4571	WAL620490
P-EGES 10 SR-WD-VI-SV-1.4571	WAL620545
P-EGES 12 SR-WD-VI-SV-1.4571	WAL620407
P-EGES 12 S/R 1/2-WD-VI-SV-1.4571	WAL620546
P-EGES 14 SR-WD-VI-SV-1.4571	WAL621473
P-EGES 16 SR-WD-VI-SV-1.4571	WAL620532
P-EGES 16 S/R 3/4-WD-VI-SV-1.4571	WAL623090

Typ	Reference Bestell-Nr.
<b>P-EGES ... M-WD-VI-SV-1.4571</b>	
P-EGES 6 LM-WD-VI-SV-1.4571	WAL621116
P-EGES 8 LM-WD-VI-SV-1.4571	WAL621117
P-EGES 10 LM-WD-VI-SV-1.4571	WAL620700
P-EGES 12 LM-WD-VI-SV-1.4571	WAL621118
P-EGES 15 LM-WD-VI-SV-1.4571	WAL621119
P-EGES 18 LM-WD-VI-SV-1.4571	WAL621120
P-EGES 22 LM-WD-VI-SV-1.4571	WAL621121
P-EGES 6 SM-WD-VI-SV-1.4571	WAL620701
P-EGES 8 SM-WD-VI-SV-1.4571	WAL621125
P-EGES 10 SM-WD-VI-SV-1.4571	WAL621126
P-EGES 12 SM-WD-VI-SV-1.4571	WAL621127
P-EGES 14 SM-WD-VI-SV-1.4571	WAL621472
P-EGES 16 SM-WD-VI-SV-1.4571	WAL620657

...  
with taper, O-Ring and captive seal  
Stud thread: BSP thread (parallel)

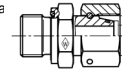

...  
mit Dichtkegel, O-Ring und Weichdichtung  
Einschraubgewinde: Whitworth-Rohrgewinde (zylindrisch)

Typ	Reference Bestell-Nr.
<b>EGESD ... R-WD-VI-1.4571</b>	
EGESD 6 LR-WD-VI-1.4571	WAL615162
EGESD 8 LR-WD-VI-1.4571	WAL374950
EGESD 10 LR-WD-VI-1.4571	WAL371550
EGESD 12 LR-WD-VI-1.4571	WAL372579
EGESD 12 L/R 1/4-WD-VI-1.4571	WAL615354
EGESD 15 LR-WD-VI-1.4571	WAL371553
EGESD 18 LR-WD-VI-1.4571	WAL371556
EGESD 22 LR-WD-VI-1.4571	WAL372751
EGESD 28 LR-WD-VI-1.4571	WAL604194
EGESD 35 LR-WD-VI-1.4571	WAL604648
EGESD 42 LR-WD-VI-1.4571	WAL372348
EGESD 6 SR-WD-VI-1.4571	WAL615654
EGESD 8 SR-WD-VI-1.4571	WAL068481
EGESD 10 SR-WD-VI-1.4571	WAL608620
EGESD 12 SR-WD-VI-1.4571	WAL606820
EGESD 12 S/R 1/2-WD-VI-1.4571	WAL372581
EGESD 14 SR-WD-VI-1.4571	WAL617616
EGESD 16 SR-WD-VI-1.4571	WAL370609
EGESD 20 SR-WD-VI-1.4571	WAL068479
EGESD 25 SR-WD-VI-1.4571	WAL372587
EGESD 30 SR-WD-VI-1.4571	WAL372332
EGESD 38 SR-WD-VI-1.4571	WAL370961

...  
with taper, O-Ring and captive seal  
Stud thread: BSP thread (parallel)

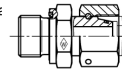

...  
mit Dichtkegel, O-Ring und Weichdichtung  
Einschraubgewinde: Whitworth-Rohrgewinde (zylindrisch)

Typ	Reference Bestell-Nr.
<b>EGESD ... M-WD-VI-1.4571</b>	
EGESD 6 LM-WD-VI - 1.4571	WAL602795
EGESD 8 LM-WD-VI - 1.4571	WAL617617
EGESD 10 LM-WD-VI - 1.4571	WAL615649
EGESD 12 LM-WD-VI - 1.4571	WAL613252
EGESD 15 LM-WD-VI - 1.4571	WAL617618
EGESD 18 LM-WD-VI - 1.4571	WAL615369
EGESD 22 LM-WD-VI - 1.4571	WAL615318
EGESD 28 LM-WD-VI - 1.4571	WAL617619
EGESD 35 LM-WD-VI - 1.4571	WAL615713
EGESD 42 LM-WD-VI - 1.4571	WAL617620
EGESD 6 SM-WD-VI - 1.4571	WAL617621
EGESD 8 SM-WD-VI - 1.4571	WAL617622
EGESD 10 SM-WD-VI - 1.4571	WAL617623
EGESD 12 SM-WD-VI - 1.4571	WAL617624
EGESD 14 SM-WD-VI - 1.4571	WAL615219
EGESD 16 SM-WD-VI - 1.4571	WAL607908
EGESD 20 SM-WD-VI - 1.4571	WAL610674
EGESD 25 SM-WD-VI - 1.4571	WAL617625
EGESD 30 SM-WD-VI - 1.4571	WAL610619
EGESD 38 SM-WD-VI - 1.4571	WAL617626



**Stud standpipe adaptor (body only)**

with taper and O-Ring  
Stud thread: NPT

**Gerade Einschraubstutzen**  
mit Dichtkegel und O-Ring  
Einschraubgewinde: NPT

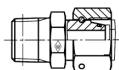

Typ	Reference Bestell-Nr.
<b>EGESD ... NPT-VI-1.4571</b>	
EGESD 6 L/ 1/8-NPT-VI-1.4571	WAL617627
EGESD 8 L/ 1/4-NPT-VI-1.4571	WAL617628
EGESD 10 L/ 1/4-NPT-VI-1.4571	WAL617629
EGESD 12 L/ 3/8-NPT-VI-1.4571	WAL615256
EGESD 15 L/ 1/2-NPT-VI-1.4571	WAL617630
EGESD 18 L/ 1/2-NPT-VI-1.4571	WAL617631
EGESD 22 L/ 3/4-NPT-VI-1.4571	WAL617632
EGESD 28 L/ 1-NPT-VI-1.4571	WAL618291
EGESD 35 L/ 1 1/4-NPT-VI-1.4571	WAL617633
EGESD 42 L/ 1 1/2-NPT-VI-1.4571	WAL617634

Typ	Reference Bestell-Nr.
<b>EGESD ... NPT-VI-1.4571</b>	
EGESD 6 S/ 1/4-NPT-VI-1.4571	WAL617635
EGESD 8 S/ 1/4-NPT-VI-1.4571	WAL617636
EGESD 10 S/ 3/8-NPT-VI-1.4571	WAL617637
EGESD 12 S/ 3/8-NPT-VI-1.4571	WAL618292
EGESD 14 S/ 1/2-NPT-VI-1.4571	WAL617638
EGESD 16 S/ 1/2-NPT-VI-1.4571	WAL617639
EGESD 20 S/ 3/4-NPT-VI-1.4571	WAL617640
EGESD 25 S/ 1-NPT-VI-1.4571	WAL618293
EGESD 30 S/ 1 1/4-NPT-VI-1.4571	WAL617641
EGESD 38 S/ 1 1/2-NPT-VI-1.4571	WAL617642

**Straight coupling**

taper and O-Ring on both sides

**Gerade-Verbindung**  
beidseitig Dichtkegel und O-Ring

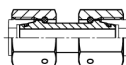

Typ	Reference Bestell-Nr.
<b>SNV ... -L-VI-1.4571</b>	
SNV 6 L-VI - 1.4571	WAL605650
SNV 8 L-VI - 1.4571	WAL614821
SNV 10 L-VI - 1.4571	WAL614822
SNV 12 L-VI - 1.4571	WAL602792
SNV 15 L-VI - 1.4571	WAL613125
SNV 18 L-VI - 1.4571	WAL613126
SNV 22 L-VI - 1.4571	WAL613249
SNV 28 L-VI - 1.4571	WAL615448
SNV 35 L-VI - 1.4571	WAL615456
SNV 42 L-VI - 1.4571	WAL615609

Typ	Reference Bestell-Nr.
<b>SNV ... -S-VI-1.4571</b>	
SNV 6 S-VI - 1.4571	WAL617643
SNV 8 S-VI - 1.4571	WAL607143
SNV 10 S-VI - 1.4571	WAL613325
SNV 12 S-VI - 1.4571	WAL604350
SNV 14 S-VI - 1.4571	WAL617644
SNV 16 S-VI - 1.4571	WAL610011
SNV 20 S-VI - 1.4571	WAL605521
SNV 25 S-VI - 1.4571	WAL605522
SNV 30 S-VI - 1.4571	WAL613266
SNV 38 S-VI - 1.4571	WAL606413

**Non-return-valve**

tube connection both ends

**Rückschlagventil**  
beidseitiger Rohranschluß



**Profile ring  
Profiling**

**Body only  
Stutzen**

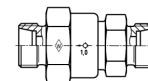

Typ	Reference Bestell-Nr.
<b>P-RV ... -1.4571-AGM</b>	
P-RV 15 L-1.4571-AGM	WAL621885
P-RV 18 L-1.4571-AGM	WAL621891
P-RV 22 L-1.4571-AGM	WAL621854
P-RV 28 L-1.4571-AGM	WAL621843
P-RV 35 L-1.4571-AGM	WAL623156
P-RV 42 L-1.4571-AGM	WAL623157

Typ	Reference Bestell-Nr.
<b>P-RV ... -1.4571</b>	
P-RV 6 L-1.4571	WAL620511
P-RV 8 L-1.4571	WAL620510
P-RV 10 L-1.4571	WAL620383
P-RV 12 L-1.4571	WAL620461
P-RV 15 L-1.4571	WAL620458
P-RV 18 L-1.4571	WAL620467
P-RV 22 L-1.4571	WAL620404
P-RV 28 L-1.4571	WAL620389
P-RV 35 L-1.4571	WAL621556
P-RV 42 L-1.4571	WAL621558

Typ	Reference Bestell-Nr.
<b>RS ... -1.4571</b>	
RS 6 L-1.4571	WAL604852
RS 8 L-1.4571	WAL604850
RS 10 L-1.4571	WAL602518
RS 12 L-1.4571	WAL370758
RS 15 L-1.4571	WAL602473
RS 18 L-1.4571	WAL604499
RS 22 L-1.4571	WAL603962
RS 28 L-1.4571	WAL602724
RS 35 L-1.4571	WAL617645
RS 42 L-1.4571	WAL617646

P-RV 12 S-1.4571-AGM	WAL622024
P-RV 14 S-1.4571-AGM	WAL623158
P-RV 16 S-1.4571-AGM	WAL622025
P-RV 20 S-1.4571-AGM	WAL623159
P-RV 25 S-1.4571-AGM	WAL621827
P-RV 30 S-1.4571-AGM	WAL623160
P-RV 38 S-1.4571-AGM	WAL623161

P-RV 6 S-1.4571	WAL621559
P-RV 8 S-1.4571	WAL620707
P-RV 10 S-1.4571	WAL621546
P-RV 12 S-1.4571	WAL620708
P-RV 14 S-1.4571	WAL621549
P-RV 16 S-1.4571	WAL620709
P-RV 20 S-1.4571	WAL621552
P-RV 25 S-1.4571	WAL620349
P-RV 30 S-1.4571	WAL621554
P-RV 38 S-1.4571	WAL621557

RS 6 S-1.4571	WAL617647
RS 8 S-1.4571	WAL607288
RS 10 S-1.4571	WAL617648
RS 12 S-1.4571	WAL602552
RS 14 S-1.4571	WAL617649
RS 16 S-1.4571	WAL606504
RS 20 S-1.4571	WAL374975
RS 25 S-1.4571	WAL372145
RS 30 S-1.4571	WAL617650
RS 38 S-1.4571	WAL374976







**Reducing fitting**  
Series L  
with taper and O-Ring

**Reduzierschraubung**  
Baureihe L  
mit Dichtkegel und O-Ring



**Profile ring  
Profiling**

**Body only  
Stutzen**

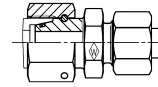

Typ	Reference Bestell-Nr.
<b>P-REDVD ... L-VI-1.4571-AGM</b>	
P-REDVD 8/ 6 L-VI-1.4571	
P-REDVD 10/ 6 L-VI-1.4571	
P-REDVD 10/ 8 L-VI-1.4571	
P-REDVD 12/ 6 L-VI-1.4571	
P-REDVD 12/ 8 L-VI-1.4571	
P-REDVD 12/10 L-VI-1.4571	
P-REDVD 15/ 6 L-VI-1.4571	
P-REDVD 15/ 8 L-VI-1.4571	
P-REDVD 15/10 L-VI-1.4571	
P-REDVD 15/12 L-VI-1.4571	
P-REDVD 18/ 6 L-VI-1.4571	
P-REDVD 18/ 8 L-VI-1.4571	
P-REDVD 18/10 L-VI-1.4571	
P-REDVD 18/15 L-VI-1.4571-AGM	WAL622416
P-REDVD 22/ 8 L-VI-1.4571	
P-REDVD 22/10 L-VI-1.4571	
P-REDVD 22/12 L-VI-1.4571	
P-REDVD 22/15 L-VI-1.4571-AGM	WAL622417
P-REDVD 22/18 L-VI-1.4571-AGM	WAL622418
P-REDVD 28/15 L-VI-1.4571-AGM	WAL622419
P-REDVD 28/18 L-VI-1.4571-AGM	WAL622420
P-REDVD 28/22 L-VI-1.4571-AGM	WAL622421
P-REDVD 35/15 L-VI-1.4571-AGM	WAL622422
P-REDVD 35/18 L-VI-1.4571-AGM	WAL622423
P-REDVD 35/22 L-VI-1.4571-AGM	WAL622424
P-REDVD 35/28 L-VI-1.4571-AGM	WAL622425
P-REDVD 42/15 L-VI-1.4571-AGM	WAL622426
P-REDVD 42/18 L-VI-1.4571-AGM	WAL622427
P-REDVD 42/22 L-VI-1.4571-AGM	WAL622428
P-REDVD 42/28 L-VI-1.4571-AGM	WAL622429
P-REDVD 42/35 L-VI-1.4571-AGM	WAL622430

Typ	Reference Bestell-Nr.
<b>P-REDVD ... L-VI-1.4571</b>	
P-REDVD 8/ 6 L-VI-1.4571	WAL621368
P-REDVD 10/ 6 L-VI-1.4571	WAL621369
P-REDVD 10/ 8 L-VI-1.4571	WAL621370
P-REDVD 12/ 6 L-VI-1.4571	WAL621371
P-REDVD 12/ 8 L-VI-1.4571	WAL621372
P-REDVD 12/10 L-VI-1.4571	WAL621373
P-REDVD 15/ 6 L-VI-1.4571	WAL621374
P-REDVD 15/ 8 L-VI-1.4571	WAL621375
P-REDVD 15/10 L-VI-1.4571	WAL621376
P-REDVD 15/12 L-VI-1.4571	WAL621377
P-REDVD 18/ 6 L-VI-1.4571	WAL621378
P-REDVD 18/ 8 L-VI-1.4571	WAL621379
P-REDVD 18/10 L-VI-1.4571	WAL621380
P-REDVD 18/12 L-VI-1.4571	WAL621381
P-REDVD 18/15 L-VI-1.4571	WAL621382
P-REDVD 22/ 6 L-VI-1.4571	WAL621383
P-REDVD 22/ 8 L-VI-1.4571	WAL621384
P-REDVD 22/10 L-VI-1.4571	WAL621385
P-REDVD 22/12 L-VI-1.4571	WAL621386
P-REDVD 22/15 L-VI-1.4571	WAL621387
P-REDVD 22/18 L-VI-1.4571	WAL621388
P-REDVD 28/ 6 L-VI-1.4571	WAL621389
P-REDVD 28/ 8 L-VI-1.4571	WAL621390
P-REDVD 28/10 L-VI-1.4571	WAL621391
P-REDVD 28/12 L-VI-1.4571	WAL621392
P-REDVD 28/15 L-VI-1.4571	WAL621393
P-REDVD 28/18 L-VI-1.4571	WAL621394
P-REDVD 28/22 L-VI-1.4571	WAL621395
P-REDVD 35/ 6 L-VI-1.4571	WAL621396
P-REDVD 35/ 8 L-VI-1.4571	WAL621397
P-REDVD 35/10 L-VI-1.4571	WAL621398
P-REDVD 35/12 L-VI-1.4571	WAL621399
P-REDVD 35/15 L-VI-1.4571	WAL621400
P-REDVD 35/18 L-VI-1.4571	WAL621401
P-REDVD 35/22 L-VI-1.4571	WAL621402
P-REDVD 35/28 L-VI-1.4571	WAL621403
P-REDVD 42/ 6 L-VI-1.4571	WAL623091
P-REDVD 42/ 8 L-VI-1.4571	WAL623093
P-REDVD 42/10 L-VI-1.4571	WAL621404
P-REDVD 42/12 L-VI-1.4571	WAL621405
P-REDVD 42/15 L-VI-1.4571	WAL621406
P-REDVD 42/18 L-VI-1.4571	WAL621407
P-REDVD 42/22 L-VI-1.4571	WAL621408
P-REDVD 42/28 L-VI-1.4571	WAL621409
P-REDVD 42/35 L-VI-1.4571	WAL621410

Typ	Reference Bestell-Nr.
<b>RESDSD ... L-VI-1.4571</b>	
RESDSD 8/ 6 L-VI-1.4571	WAL618337
RESDSD 10/ 6 L-VI-1.4571	WAL618338
RESDSD 10/ 8 L-VI-1.4571	WAL618339
RESDSD 12/ 6 L-VI-1.4571	WAL618340
RESDSD 12/ 8 L-VI-1.4571	WAL618341
RESDSD 12/10 L-VI-1.4571	WAL618342
RESDSD 15/ 6 L-VI-1.4571	WAL618343
RESDSD 15/ 8 L-VI-1.4571	WAL618344
RESDSD 15/10 L-VI-1.4571	WAL618345
RESDSD 15/12 L-VI-1.4571	WAL618346
RESDSD 18/ 6 L-VI-1.4571	WAL618347
RESDSD 18/ 8 L-VI-1.4571	WAL618348
RESDSD 18/10 L-VI-1.4571	WAL618349
RESDSD 18/12 L-VI-1.4571	WAL618350
RESDSD 18/15 L-VI-1.4571	WAL618351
RESDSD 22/ 6 L-VI-1.4571	WAL618352
RESDSD 22/ 8 L-VI-1.4571	WAL618353
RESDSD 22/10 L-VI-1.4571	WAL618354
RESDSD 22/12 L-VI-1.4571	WAL618355
RESDSD 22/15 L-VI-1.4571	WAL618356
RESDSD 22/18 L-VI-1.4571	WAL618357
RESDSD 28/ 6 L-VI-1.4571	WAL618358
RESDSD 28/ 8 L-VI-1.4571	WAL618359
RESDSD 28/10 L-VI-1.4571	WAL618360
RESDSD 28/12 L-VI-1.4571	WAL618361
RESDSD 28/15 L-VI-1.4571	WAL618362
RESDSD 28/18 L-VI-1.4571	WAL618363
RESDSD 28/22 L-VI-1.4571	WAL618364
RESDSD 35/ 6 L-VI-1.4571	WAL618365
RESDSD 35/ 8 L-VI-1.4571	WAL618366
RESDSD 35/10 L-VI-1.4571	WAL618367
RESDSD 35/12 L-VI-1.4571	WAL618368
RESDSD 35/15 L-VI-1.4571	WAL618369
RESDSD 35/18 L-VI-1.4571	WAL618370
RESDSD 35/22 L-VI-1.4571	WAL618371
RESDSD 35/28 L-VI-1.4571	WAL618372
RESDSD 42/ 6 L-VI-1.4571	WAL623092
RESDSD 42/ 8 L-VI-1.4571	WAL623094
RESDSD 42/10 L-VI-1.4571	WAL618373
RESDSD 42/12 L-VI-1.4571	WAL618374
RESDSD 42/15 L-VI-1.4571	WAL618375
RESDSD 42/18 L-VI-1.4571	WAL618376
RESDSD 42/22 L-VI-1.4571	WAL618377
RESDSD 42/28 L-VI-1.4571	WAL618378
RESDSD 42/35 L-VI-1.4571	WAL618379

**Reducing fitting**  
Series S  
with taper and O-Ring

**Reduzierschraubung**  
Baureihe S  
mit Dichtkegel und O-Ring

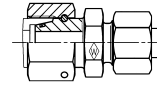

**Profile ring  
Profiling**

**Body only  
Stutzen**

Typ	Reference Bestell-Nr.
<b>P-REDVD ... S-VI-1.4571-AGM</b>	
P-REDVD 14/12 S-VI-1.4571-AGM	WAL622431
P-REDVD 16/12 S-VI-1.4571-AGM	WAL622432
P-REDVD 16/14 S-VI-1.4571-AGM	WAL622433
P-REDVD 20/12 S-VI-1.4571-AGM	WAL622434
P-REDVD 20/14 S-VI-1.4571-AGM	WAL622435
P-REDVD 20/16 S-VI-1.4571-AGM	WAL622436
P-REDVD 25/12 S-VI-1.4571-AGM	WAL622437
P-REDVD 25/14 S-VI-1.4571-AGM	WAL622438
P-REDVD 25/16 S-VI-1.4571-AGM	WAL622439
P-REDVD 25/20 S-VI-1.4571-AGM	WAL622440
P-REDVD 30/12 S-VI-1.4571-AGM	WAL622441
P-REDVD 30/14 S-VI-1.4571-AGM	WAL622442
P-REDVD 30/16 S-VI-1.4571-AGM	WAL623097
P-REDVD 30/20 S-VI-1.4571-AGM	WAL622444
P-REDVD 30/25 S-VI-1.4571-AGM	WAL622445
P-REDVD 38/12 S-VI-1.4571-AGM	WAL622446
P-REDVD 38/14 S-VI-1.4571-AGM	WAL622447
P-REDVD 38/16 S-VI-1.4571-AGM	WAL622448
P-REDVD 38/20 S-VI-1.4571-AGM	WAL622449
P-REDVD 38/25 S-VI-1.4571-AGM	WAL622450
P-REDVD 38/30 S-VI-1.4571-AGM	WAL622451

Typ	Reference Bestell-Nr.
<b>P-REDVD ... S-VI-1.4571</b>	
P-REDVD 8/ 6 S-VI-1.4571	WAL621411
P-REDVD 10/ 6 S-VI-1.4571	WAL621412
P-REDVD 10/ 8 S-VI-1.4571	WAL621413
P-REDVD 12/ 6 S-VI-1.4571	WAL621414
P-REDVD 12/ 8 S-VI-1.4571	WAL621415
P-REDVD 12/10 S-VI-1.4571	WAL621416
P-REDVD 14/ 6 S-VI-1.4571	WAL621417
P-REDVD 14/ 8 S-VI-1.4571	WAL621418
P-REDVD 14/10 S-VI-1.4571	WAL621419
P-REDVD 14/12 S-VI-1.4571	WAL621420
P-REDVD 16/ 6 S-VI-1.4571	WAL621421
P-REDVD 16/ 8 S-VI-1.4571	WAL621422
P-REDVD 16/10 S-VI-1.4571	WAL621423
P-REDVD 16/12 S-VI-1.4571	WAL621424
P-REDVD 16/14 S-VI-1.4571	WAL621425
P-REDVD 20/ 6 S-VI-1.4571	WAL621426
P-REDVD 20/ 8 S-VI-1.4571	WAL621427
P-REDVD 20/10 S-VI-1.4571	WAL621428
P-REDVD 20/12 S-VI-1.4571	WAL621429
P-REDVD 20/14 S-VI-1.4571	WAL621430
P-REDVD 20/16 S-VI-1.4571	WAL621431
P-REDVD 25/ 6 S-VI-1.4571	WAL621432
P-REDVD 25/ 8 S-VI-1.4571	WAL621433
P-REDVD 25/10 S-VI-1.4571	WAL621434
P-REDVD 25/12 S-VI-1.4571	WAL621435
P-REDVD 25/14 S-VI-1.4571	WAL621436
P-REDVD 25/16 S-VI-1.4571	WAL621437
P-REDVD 25/20 S-VI-1.4571	WAL621438
P-REDVD 30/ 6 S-VI-1.4571	WAL621439
P-REDVD 30/ 8 S-VI-1.4571	WAL621440
P-REDVD 30/10 S-VI-1.4571	WAL621441
P-REDVD 30/12 S-VI-1.4571	WAL621442
P-REDVD 30/14 S-VI-1.4571	WAL621443
P-REDVD 30/16 S-VI-1.4571	WAL621444
P-REDVD 30/20 S-VI-1.4571	WAL621445
P-REDVD 30/25 S-VI-1.4571	WAL621446
P-REDVD 38/ 6 S-VI-1.4571	WAL621447
P-REDVD 38/ 8 S-VI-1.4571	WAL621448
P-REDVD 38/10 S-VI-1.4571	WAL621449
P-REDVD 38/12 S-VI-1.4571	WAL621450
P-REDVD 38/14 S-VI-1.4571	WAL621451
P-REDVD 38/16 S-VI-1.4571	WAL621452
P-REDVD 38/20 S-VI-1.4571	WAL621453
P-REDVD 38/25 S-VI-1.4571	WAL621454
P-REDVD 38/30 S-VI-1.4571	WAL621455

Typ	Reference Bestell-Nr.
<b>RESDSD ... S-VI-1.4571</b>	
RESDSD 8/ 6 S-VI-1.4571	WAL618425
RESDSD 10/ 6 S-VI-1.4571	WAL618426
RESDSD 10/ 8 S-VI-1.4571	WAL618427
RESDSD 12/ 6 S-VI-1.4571	WAL618428
RESDSD 12/ 8 S-VI-1.4571	WAL618429
RESDSD 12/10 S-VI-1.4571	WAL618430
RESDSD 14/ 6 S-VI-1.4571	WAL618431
RESDSD 14/ 8 S-VI-1.4571	WAL618432
RESDSD 14/10 S-VI-1.4571	WAL618433
RESDSD 14/12 S-VI-1.4571	WAL618434
RESDSD 16/ 6 S-VI-1.4571	WAL618435
RESDSD 16/ 8 S-VI-1.4571	WAL618436
RESDSD 16/10 S-VI-1.4571	WAL618437
RESDSD 16/12 S-VI-1.4571	WAL618438
RESDSD 16/14 S-VI-1.4571	WAL618439
RESDSD 20/ 6 S-VI-1.4571	WAL618440
RESDSD 20/ 8 S-VI-1.4571	WAL618441
RESDSD 20/10 S-VI-1.4571	WAL618442
RESDSD 20/12 S-VI-1.4571	WAL067812
RESDSD 20/14 S-VI-1.4571	WAL618443
RESDSD 20/16 S-VI-1.4571	WAL067813
RESDSD 25/ 6 S-VI-1.4571	WAL618444
RESDSD 25/ 8 S-VI-1.4571	WAL618445
RESDSD 25/10 S-VI-1.4571	WAL618446
RESDSD 25/12 S-VI-1.4571	WAL618447
RESDSD 25/14 S-VI-1.4571	WAL618448
RESDSD 25/16 S-VI-1.4571	WAL067814
RESDSD 25/20 S-VI-1.4571	WAL618449
RESDSD 30/ 6 S-VI-1.4571	WAL618450
RESDSD 30/ 8 S-VI-1.4571	WAL618451
RESDSD 30/10 S-VI-1.4571	WAL618452
RESDSD 30/12 S-VI-1.4571	WAL618453
RESDSD 30/14 S-VI-1.4571	WAL618454
RESDSD 30/16 S-VI-1.4571	WAL618455
RESDSD 30/20 S-VI-1.4571	WAL067815
RESDSD 30/25 S-VI-1.4571	WAL618456
RESDSD 38/ 6 S-VI-1.4571	WAL618457
RESDSD 38/ 8 S-VI-1.4571	WAL618458
RESDSD 38/10 S-VI-1.4571	WAL618459
RESDSD 38/12 S-VI-1.4571	WAL618460
RESDSD 38/14 S-VI-1.4571	WAL618461
RESDSD 38/16 S-VI-1.4571	WAL618462
RESDSD 38/20 S-VI-1.4571	WAL618463
RESDSD 38/25 S-VI-1.4571	WAL618464
RESDSD 38/30 S-VI-1.4571	WAL067816

**Reducing adaptor**  
with captive seal  
BSP thread (parallel)

**Gewinde-Reduzierstutzen**  
mit Weichdichtung  
Whitworth-Rohrgewinde  
(zylindrisch)

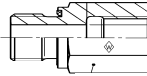

Typ	Reference Bestell-Nr.
<b>RED-R ... -WD-VI / R ... -1.4571</b>	
RED-R 3/8-WD-VI/R 1/8-1.4571	WAL612428
RED-R 1/2-WD-VI/R 1/8-1.4571	WAL617813
RED-R 1/2-WD-VI/R 1/4-1.4571	WAL610622
RED-R 3/4-WD-VI/R 1/4-1.4571	WAL611180
RED-R 3/4-WD-VI/R 3/8-1.4571	WAL612089
RED-R 1-WD-VI/R 1/4-1.4571	WAL615116
RED-R 1-WD-VI/R 3/8-1.4571	WAL617814
RED-R 1-WD-VI/R 1/2-1.4571	WAL611254
RED-R 1 1/4-WD-VI/R 1/2-1.4571	WAL613813
RED-R 1 1/4-WD-VI/R 3/4-1.4571	WAL612044
RED-R 1 1/2-WD-VI/R 1/2-1.4571	WAL613127
RED-R 1 1/2-WD-VI/R 3/4-1.4571	WAL615258
RED-R 1 1/2-WD-VI/R 1-1.4571	WAL612103

Typ	Reference Bestell-Nr.
<b>RED-R ... -WD-VI / R ... -1.4571</b>	
RED-R 1/8-WD-VI/R 1/4-1.4571	WAL612430
RED-R 1/8-WD-VI/R 3/8-1.4571	WAL612431
RED-R 1/4-WD-VI/R 1/8-1.4571	WAL615402
RED-R 1/4-WD-VI/R 3/8-1.4571	WAL610621
RED-R 1/4-WD-VI/R 1/2-1.4571	WAL610620
RED-R 1/4-WD-VI/R 3/4-1.4571	WAL617815
RED-R 3/8-WD-VI/R 1/4-1.4571	WAL615403
RED-R 3/8-WD-VI/R 1/2-1.4571	WAL612429
RED-R 3/8-WD-VI/R 3/4-1.4571	WAL615482
RED-R 1/2-WD-VI/R 3/8-1.4571	WAL612095
RED-R 1/2-WD-VI/R 3/4-1.4571	WAL611320
RED-R 1/2-WD-VI/R 1-1.4571	WAL612928
RED-R 1/2-WD-VI/R 1 1/4-1.4571	WAL615487

Typ	Reference Bestell-Nr.
<b>RED-R ... -WD-VI / R ... -1.4571</b>	
RED-R 3/4-WD-VI/R 1/2-1.4571	WAL612017
RED-R 3/4-WD-VI/R 1-1.4571	WAL615220
RED-R 3/4-WD-VI/R 1 1/4-1.4571	WAL615412
RED-R 3/4-WD-VI/R 1 1/2-1.4571	WAL615508
RED-R 1-WD-VI/R 3/4-1.4571	WAL611989
RED-R 1-WD-VI/R 1 1/4-1.4571	WAL611321
RED-R 1-WD-VI/R 1 1/2-1.4571	WAL615411
RED-R 1 1/4-WD-VI/R 1-1.4571	WAL611629
RED-R 1 1/4-WD-VI/R 1 1/2-1.4571	WAL615483
RED-R 1 1/2-WD-VI/R 1 1/4-1.4571	WAL615231

**Parallel female stud coupling**  
BSP thread

**Gerade-Aufschraubverschraubung**  
Whitworth-Rohrgewinde

Typ	Reference Bestell-Nr.
<b>P-GAV ... R-1.4571-AGM</b>	
P-GAV 15 LR-1.4571-AGM	WAL621750
P-GAV 18 LR-1.4571-AGM	WAL621789
P-GAV 22 LR-1.4571-AGM	WAL621760
P-GAV 28 LR-1.4571-AGM	WAL621791
P-GAV 35 LR-1.4571-AGM	WAL621906
P-GAV 42 LR-1.4571-AGM	WAL622037
P-GAV 12 SR-1.4571-AGM	WAL621807
P-GAV 14 SR-1.4571-AGM	WAL621930
P-GAV 16 SR-1.4571-AGM	WAL621796
P-GAV 20 SR-1.4571-AGM	WAL621815
P-GAV 25 SR-1.4571-AGM	WAL621824
P-GAV 30 SR-1.4571-AGM	WAL622038
P-GAV 38 SR-1.4571-AGM	WAL622039



**Profile ring  
Profiling**

Typ	Reference Bestell-Nr.
<b>P-GAV ... R-1.4571</b>	
P-GAV 6 LR-1.4571	WAL621217
P-GAV 8 LR-1.4571	WAL620364
P-GAV 10 LR-1.4571	WAL620241
P-GAV 12 LR-1.4571	WAL620284
P-GAV 12 LR 1/4-1.4571	WAL620365
P-GAV 15 LR-1.4571	WAL620201
P-GAV 18 LR-1.4571	WAL620278
P-GAV 22 LR-1.4571	WAL620219
P-GAV 28 LR-1.4571	WAL620281
P-GAV 35 LR-1.4571	WAL620494
P-GAV 42 LR-1.4571	WAL620722
P-GAV 6 SR-1.4571	WAL620000
P-GAV 8 SR-1.4571	WAL620308
P-GAV 10 SR-1.4571	WAL620233
P-GAV 12 SR-1.4571	WAL620309
P-GAV 14 SR-1.4571	WAL620531
P-GAV 16 SR-1.4571	WAL620293
P-GAV 20 SR-1.4571	WAL620323
P-GAV 25 SR-1.4571	WAL620342
P-GAV 30 SR-1.4571	WAL620723
P-GAV 38 SR-1.4571	WAL620724

**Body only  
Stutzen**

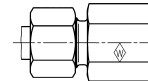

Typ	Reference Bestell-Nr.
<b>GAS ... R-1.4571</b>	
GAS 6 LR-1.4571	WAL061994
GAS 8 LR-1.4571	WAL060717
GAS 10 LR-1.4571	WAL065914
GAS 12 LR-1.4571	WAL060759
GAS 12 LR 1/4-1.4571	WAL065915
GAS 15 LR-1.4571	WAL065916
GAS 18 LR-1.4571	WAL063099
GAS 22 LR-1.4571	WAL065917
GAS 28 LR-1.4571	WAL065918
GAS 35 LR-1.4571	WAL065919
GAS 42 LR-1.4571	WAL065920
GAS 6 SR-1.4571	WAL024001
GAS 8 SR-1.4571	WAL065921
GAS 10 SR-1.4571	WAL061840
GAS 12 SR-1.4571	WAL024535
GAS 14 SR-1.4571	WAL065922
GAS 16 SR-1.4571	WAL061007
GAS 20 SR-1.4571	WAL065923
GAS 25 SR-1.4571	WAL065924
GAS 30 SR-1.4571	WAL065925
GAS 38 SR-1.4571	WAL065926

**Adjustable gauge coupling**  
with taper and O-Ring

**Einstellbarer Manometer-Aufschraubstutzen**  
mit Dichtkegel u. O-Ring

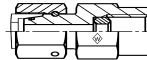

Typ	Bestell-Nr. Reference
<b>EMASD ... R-VI-1.4571</b>	
EMASD 6 LR-VI-1.4571	WAL615259
EMASD 8 LR-VI-1.4571	WAL617825
EMASD 10 LR-VI-1.4571	WAL617826
EMASD 12 LR-VI-1.4571	WAL614847

Typ	Bestell-Nr. Reference
<b>EMASD ... R-VI-1.4571</b>	
EMASD 6 SR-VI-1.4571	WAL617827
EMASD 8 SR-VI-1.4571	WAL615584
EMASD 10 SR-VI-1.4571	WAL615441
EMASD 12 SR-VI-1.4571	WAL617828

**Adjustable gauge coupling**  
BSP thread

**Manometer-Aufschraubverschraubung**  
Whitworth-Rohrgewinde

Typ	Reference Bestell-Nr.
<b>P-MAV ... R-1.4571-AGM</b>	
P-MAV 12 SR-1.4571-AGM	WAL621720



**Profile ring  
Profiling**

Typ	Reference Bestell-Nr.
<b>P-MAV ... R-1.4571</b>	
P-MAV 6 LR-1.4571	WAL620112
P-MAV 8 LR-1.4571	WAL620113
P-MAV 10 LR-1.4571	WAL620114
P-MAV 12 LR-1.4571	WAL620115
P-MAV 6 SR-1.4571	WAL620116
P-MAV 8 SR-1.4571	WAL620117
P-MAV 10 SR-1.4571	WAL620118
P-MAV 12 SR-1.4571	WAL620119

**Body only  
Stutzen**

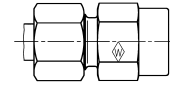

Typ	Reference Bestell-Nr.
<b>MAS ... R-1.4571</b>	
MAS 6 LR-1.4571	WAL067383
MAS 8 LR-1.4571	WAL067387
MAS 10 LR-1.4571	WAL067372
MAS 12 LR-1.4571	WAL067378
MAS 6 SR-1.4571	WAL067385
MAS 8 SR-1.4571	WAL067389
MAS 10 SR-1.4571	WAL067374
MAS 12 SR-1.4571	WAL067380

**Sealing ring  
for manometer gauge coupling**

**Dichtkantenring  
f. Manometer-Verschraubung**



Typ	Reference Bestell-Nr.
<b>DKR-R ... M-1.4571</b>	
DKR-R 1/4 M-1.4571	WAL061377
DKR-R 1/2 M-1.4571	WAL060306

**Blanking plug  
with limit stop for assembly  
with O-ring**

**Verschlussstopfen  
mit Montagebegrenzung  
mit O-Ring**

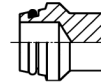

Typ	Reference Bestell-Nr.
<b>VSD ... M.MB-VI-1.4571</b>	
VSD 4 LL M.MB-VI - 1.4571	WAL618772
VSD 6 LL M.MB-VI - 1.4571	WAL618773
VSD 8 LL M.MB-VI - 1.4571	WAL618774
VSD 6 L/S M.MB-VI - 1.4571	WAL618775
VSD 8 L/S M.MB-VI - 1.4571	WAL618776
VSD 10 L/S M.MB-VI - 1.4571	WAL618777
VSD 12 L/S M.MB-VI - 1.4571	WAL618778

Typ	Reference Bestell-Nr.
<b>VSD ... M.MB-VI-1.4571</b>	
VSD 15 L M.MB-VI - 1.4571	WAL618779
VSD 18 L M.MB-VI - 1.4571	WAL618780
VSD 22 L M.MB-VI - 1.4571	WAL618781
VSD 28 L M.MB-VI - 1.4571	WAL618782
VSD 35 L M.MB-VI - 1.4571	WAL618783
VSD 42 L M.MB-VI - 1.4571	WAL618784
VSD 14 S M.MB-VI - 1.4571	WAL618785
VSD 16 S M.MB-VI - 1.4571	WAL618786
VSD 20 S M.MB-VI - 1.4571	WAL618787
VSD 25 S M.MB-VI - 1.4571	WAL618788
VSD 30 S M.MB-VI - 1.4571	WAL618789
VSD 38 S M.MB-VI - 1.4571	WAL618790

**Blanking end**  
with internal hexagon and captive seal  
Stud thread: BSP (parallel)

**Verschlusschraube**  
mit Innensechskant und Weichdichtung  
Whitworth-Rohrgewinde (zylindrisch)

Typ	Reference Bestell-Nr.
<b>VS-R ... -WD-VI-1.4571</b>	
VS-R 1/8-WD-VI-1.4571	WAL602800
VS-R 1/4-WD-VI-1.4571	WAL374787
VS-R 3/8-WD-VI-1.4571	WAL374841
VS-R 1/2-WD-VI-1.4571	WAL372597
VS-R 3/4-WD-VI-1.4571	WAL602802
VS-R 1-WD-VI-1.4571	WAL374498
VS-R 1 1/4-WD-VI-1.4571	WAL371504
VS-R 1 1/2-WD-VI-1.4571	WAL609394

Stud thread: metric (parallel)



Metrisches Gewinde (zylindrisch)

Typ	Reference Bestell-Nr.
<b>VS-M ... -WD-VI-1.4571</b>	
VS-M 10 x 1 -WD-VI-1.4571	WAL605040
VS-M 12 x 1,5-WD-VI-1.4571	WAL605042
VS-M 14 x 1,5-WD-VI-1.4571	WAL374724
VS-M 16 x 1,5-WD-VI-1.4571	WAL605044
VS-M 18 x 1,5-WD-VI-1.4571	WAL604532
VS-M 20 x 1,5-WD-VI-1.4571	WAL609395
VS-M 22 x 1,5-WD-VI-1.4571	WAL374725
VS-M 26 x 1,5-WD-VI-1.4571	WAL617296
VS-M 27 x 2 -WD-VI-1.4571	WAL605284
VS-M 33 x 2 -WD-VI-1.4571	WAL605143
VS-M 42 x 2 -WD-VI-1.4571	WAL617297
VS-M 48 x 2 -WD-VI-1.4571	WAL617298



**Tube insert**  
**Einsteckhülse**



Typ	Reference Bestell-Nr.
<b>EH ...-1.4571</b>	
EH 4-1.4571	WAL617300
EH 5-1.4571	WAL374722
EH 6-1.4571	WAL608321
EH 7-1.4571	WAL061199
EH 8-1.4571	WAL617301
EH 9-1.4571	WAL374723
EH 10-1.4571	WAL060690
EH 12-1.4571	WAL617302
EH 13-1.4571	WAL617303

Typ	Reference Bestell-Nr.
<b>EH ...-1.4571</b>	
EH 15-1.4571	WAL615587
EH 16-1.4571	WAL604537
EH 18-1.4571	WAL617304
EH 19-1.4571	WAL615586
EH 20-1.4571	WAL617305
EH 24-1.4571	WAL617306
EH 25-1.4571	WAL617307
EH 31-1.4571	WAL617308
EH 33-1.4571	WAL617309
EH 38-1.4571	WAL617310

**Welding nipple**  
with O-ring  
**Schweißnippel**  
mit O-Ring

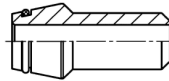

Typ	Reference Bestell-Nr.
<b>SN ... x ... -VI-1.4571</b>	
SN 8 x 2-VI-1.4571	WAL618465
SN 10 x 2-VI-1.4571	WAL602417
SN 12 x 2,5-VI-1.4571	WAL618466
SN 16 x 3-VI-1.4571	WAL604006
SN 20 x 3-VI-1.4571	WAL371960
SN 20 x 4-VI-1.4571	WAL618467
SN 25 x 3-VI-1.4571	WAL604009
SN 25 x 4-VI-1.4571	WAL618468

Typ	Reference Bestell-Nr.
<b>SN ... x ... -VI-1.4571</b>	
SN 30 x 4-VI-1.4571	WAL605679
SN 30 x 5-VI-1.4571	WAL618469
SN 30 x 6-VI-1.4571	WAL623095
SN 38 x 4-VI-1.4571	WAL606251
SN 38 x 5-VI-1.4571	WAL623300
SN 38 x 6-VI-1.4571	WAL604605
SN 38 x 7-VI-1.4571	WAL623096

**A B F Antibloc-Grease**

**A B F Anti-Bloc-Fett**

Typ	Reference Bestell-Nr.
<b>ABF ...</b>	
ABF Box/Dose à/zu 1000 g	WAL371741
ABF Tube à/zu 100 g	WAL624320